

AP

Tax # 8229001006
EL PASO COUNTY HEALTH DEPARTMENT
COLORADO SPRINGS, COLORADO

02

SEWAGE DISPOSAL INSPECTION FORM

PERMIT NUMBER 3474 P

DATE Sept. 11, 1985

APPROVAL:
YES NO

ENVIRONMENTALIST Rick Muckich

LOCATION (street number) 9885 Canyon Dr. OCCUPANT Roell

LEGAL DESCRIPTION Columbine Canyon

TYPE OF CONSTRUCTION SFR NO. OF BEDROOMS two

SYSTEM INSTALLED BY owner

COMMERCIAL MFG. precast (back) SIZE 1250

TYPE OF MATERIAL concrete NO. COMPARTMENTS two

WIDTH _____ LENGTH _____ DEPTH (total) _____ LIQ. CAP. 1250 gal.

DISPOSAL FIELD: BED OR TRENCH DEPTH _____ WIDTH _____ LENGTH _____ SQ. FT. _____

DISTANCE BETWEEN LINES _____ ROCK _____ DEPTH _____ UNDER _____ OVER _____

LEACHING PITS (NO.) two LINING MATERIAL _____ CAPACITY SQ. FT. 250

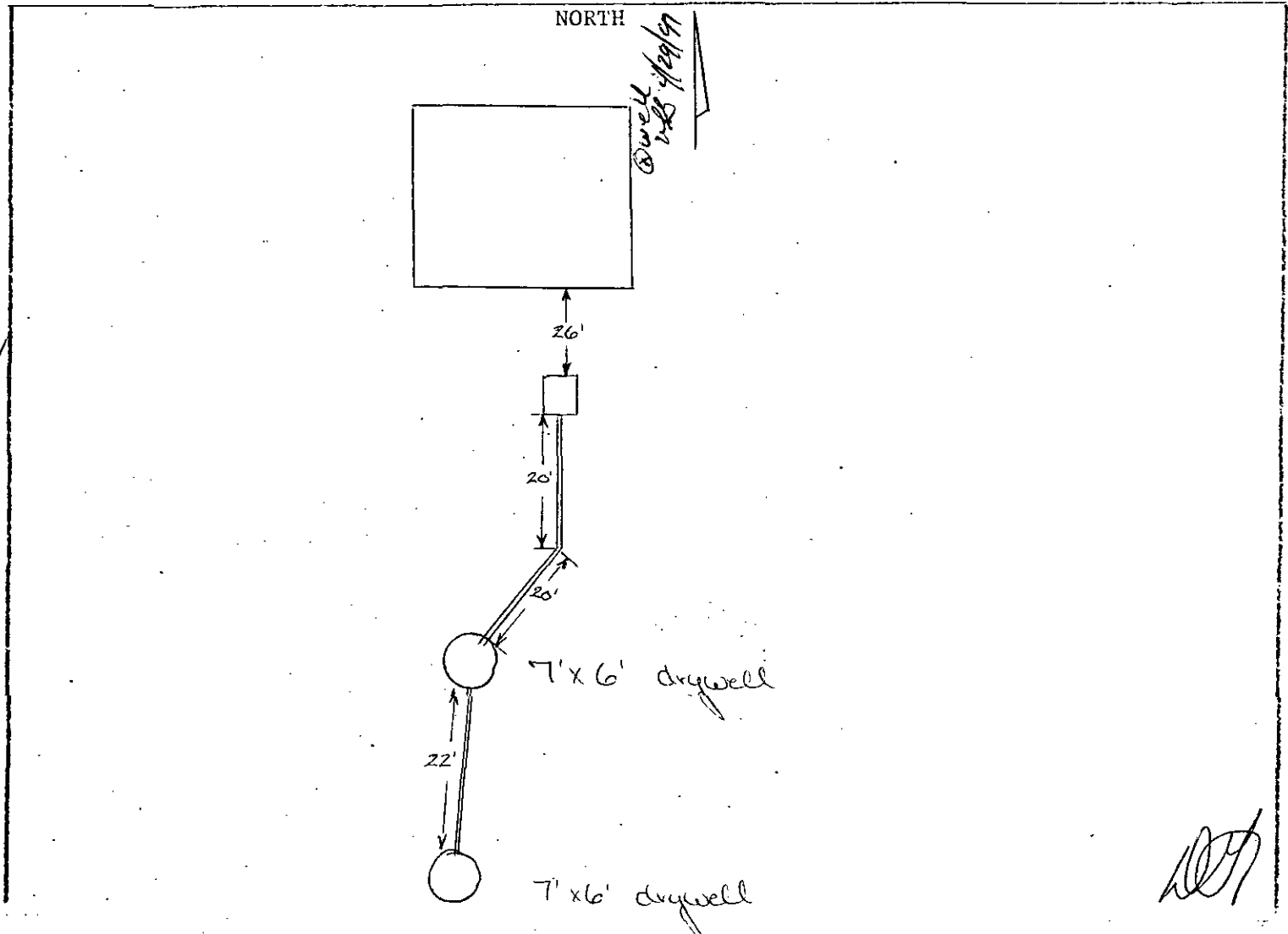

Acres 5.8

EL PASO COUNTY • COUNTY HEALTH DEPARTMENT

Permit 3474

501 North Foote Avenue • Colorado Springs, Colorado • 578-3125

Water Supply Well

Receipt No. 8168

PERMIT

TO CONSTRUCT, ALTER, REPAIR or MODIFY ANY INDIVIDUAL SEWAGE DISPOSAL SYSTEM

Issued To Theodore G. Roell

Date 7/18/85

Address of Property 9885 Canyon Drive, Lot 11, Columbine Canyon

Phone 632-2203

Sub. Filing (Permit valid at this address only) # 1, Green Mt. Falls, CO.

Sewage-Disposal System work to be performed by Lamb

Phone _____

This Permit is issued in accordance with 25-10-106 Colorado Revised Statutes 1973, as amended. PERMIT EXPIRES upon completion—installation of sewage-disposal system or at the end of six (6) months from date of issue—whichever occurs first—(unless work is in progress). This permit is revokable if all stated requirements are not met.

— THIS PERMIT DOES NOT DENOTE APPROVAL OF ZONING AND ACREAGE REQUIREMENTS —

\$150.00

PERMIT FEE (NOT REFUNDABLE)

John B. [Signature]
DIRECTOR, COUNTY HEALTH DEPARTMENT
Edward W. Jordan
ENVIRONMENTALIST

January 18, 1986

DATE OF EXPIRATION

NOTE: LEAVE ENTIRE SEWAGE-DISPOSAL SYSTEM UNCOVERED FOR FINAL INSPECTION. 48 HOUR ADVANCE NOTICE REQUIRED.

SEPTIC TANK: 1000 gallons	TRENCH SYSTEM: total square feet <u>250</u> _____ ft. of trench _____ inches wide _____ ft. of trench _____ inches wide	BED SYSTEM: total square feet _____	SEEPAGE PIT SYSTEM: total square feet <u>250</u> _____ rings or _____ diam. x _____ w/d
------------------------------	--	--	---

NOTES: Four (4) rings plus 1' rock liner (1½" river rock) plus 12" sand filter in bottom of dry well required. Minimum of 1' of cover required over shallowest portion of dry well.

The Health Office shall assume no responsibility in case of failure or inadequacy of a sewage-disposal system, beyond consulting in good faith with the property owner or representative. Free access to the property shall be authorized at reasonable times for the purpose of making such inspections as are necessary to determine compliance with requirements of this law.

El Paso County Health Department
501 North Foote Avenue
Colorado Springs, CO 80909-4598
(303) 578-3125

APPLICATION FOR A PERMIT TO CONSTRUCT, REMODEL, OR INSTALL A SEWAGE DISPOSAL SYSTEM

NAME OF OWNER Theodore G. Roell HOME PHONE 599-7759 WORK PHONE 632-2203
ADDRESS OF PROPERTY 9885 Canyon Drive DATE July 16, 1985
LEGAL DESCRIPTION OF PROPERTY Lot 11, Columbine Canyon Sub, Filing 1
TAX SCHEDULE NUMBER 822 90-01-006 SYSTEM CONTRACTOR Lamb PHONE _____
OWNER'S ADDRESS IF DIFFERENT 708
TYPE OF HOUSE CONSTRUCTION _____ SOURCE AND TYPE OF WATER SUPPLY well
SIZE OF LOT 5.8 acre MAXIMUM POTENTIAL NUMBER OF BEDROOMS 2 BASEMENT (yes or no) no
PERCOLATION TEST RESULTS ATTACHED (yes or no) yes

A plot plan and accompanying information are essential; it may be drawn on the back of this application or be attached. Please include by measured distance the location of wells including neighbors' wells, springs, water supply lines, cisterns, buildings, proposed structures, property lines, property dimensions, subsoil drains, lakes, ponds, water courses, streams, and dry gulches. Please show the location of the proposed septic system by directions and distances from actual and/or proposed dwellings, structures, or fixed reference objects. Give complete directions to the property from major highways.

Applicant acknowledges that the completeness of the application is conditional upon such further mandatory and additional tests and reports as may be required by the department to be made and furnished by the applicant for purposes of evaluation of the application; and issuance of the permit is subject to such terms and conditions as deemed necessary to ensure compliance with rules and regulations adopted under Article 10, Title 25, C.R.S. 1973 as amended. The undersigned hereby certifies that all statements made, information and reports submitted by the applicant are or will be represented to be true and correct to the best of my knowledge and belief and are designed to be relied on by the El Paso County Health Dept. in evaluating the same for purposes of issuing the permit applied for herein. I further understand that any falsification or misrepresentation may result in the denial of the application or revocation of any permit granted based upon said application and in legal action for perjury as provided by law.

SIGNATURE *Theodore G. Roell*

HEALTH DEPARTMENT USE ONLY

PERMIT NUMBER 3474 RECEIPT NUMBER 8168 DATE TO LAND USE DEPARTMENT 7/18/85
ABSORPTION AREA 250 TANK CAPACITY 1000 DATE OF SITE INSPECTION 7/8/85

REMARKS: 4 Rings plus 1" rock liner (1 1/2" river rock)
plus 12" sand filter in bottom of dry well
required. Minimum of 1' of cover required
over shallowest portion of dry well.

APPLICATION IS APPROVED () DENIED () DATE 7/18/85 ENVIRONMENTALIST *P. J. Mehl*

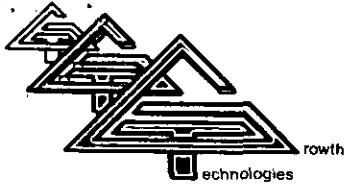

9885 Canyon Drive

8229001006

E

09-11-85

March 19, 1984

El Paso County Health Department
501 N. Foote
Colorado Springs, CO 80909

RE: Dry well ring seepage pit on Lot No. 1; Columbine Canyon, Crystola, CO

Sirs;

This letter was requested by Mr. Dwayne Dee for the above mentioned project.

The dry ring seepage pit should be constructed so that there is a minimum of one (1) foot of cover over the top of it.

Also, from the soils data shown on Mr. Dee's percolation tests, I would recommend that the pit be over sized by at least 20%.

Sincerely,

GROWTH TECHNOLOGIES CORPORATION

Michael J. Vinson

Michael J. Vinson, P.E.
Head of Engineering



MJV/jm

GROWTH TECHNOLOGIES CORPORATION

Planners, Consultants, Engineers

235 N. PINE ST., SUITE 201 • COLORADO SPRINGS, CO 80905 • (303) 578-0551

Dwayne Dee
 Dirt Contractor
 P.O. Box 299
 Woodland Park, CO 80863
 303/687/3135

DIAGRAM:

5.87 acres

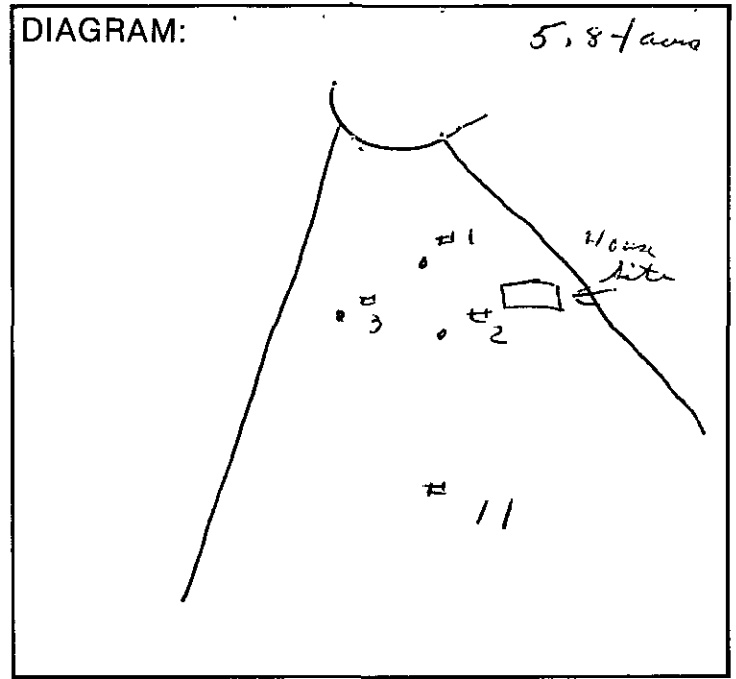

SOIL PERCOLATION TESTS

CLIENT Catherin R Colburn

TEST LOCATION Columbine Canyon

Sub Lot #1 Crystala Colo.

Trax Sublot 82290-01-006

TEST NO. 3/84/1

DATE 3/15/84

TRIAL NO.	DEPTH START, IN.	START TIME	DEPTH FINISH, IN.	FINISH TIME	TOTAL DROP INCHES	TOTAL DROP TIME, MIN.	MINUTES TO DROP 1 INCH
1	32.0	3:20	26.0	3:50	6.0	30.0	5.00
2	37.0	3:21	28.0	3:51	6.0	30.0	5.00
3	36.0	3:22	20.0	3:52	16.0	30.0	1.87
4							
AVERAGE							3.96

DATE HOLE SATURATED 3/14/84 TIME 4:00

DATE PERCOLATION TEST MADE 3/15/84 TIME 3:20

REMARKS: The Proposed dry well ring seepage pit site is located on a western slope calculated at a 37° of drop. Scattered grass with 2" of topsoil and granite mix was found above each hole. Frost was found in each hole at 3" depth. Hole #1 & 2 had decomposed granite and finer sand rock to bottom of hole. Hole #3 coarse granite and very little fine rock was found. No water found in holes next day.

Due to the degree of slope at 37° an Engineering system and open hole profile inspection will be required. System is based on a 3.94 percolation Rate

