



## ON-SITE WASTEWATER TREATMENT SYSTEM OWTS RECORD CORRECTION

Internal Use Only

### Property Information

#### Current Record Information

ON#	ON0000720	Tax Schedule #:	6323112018
Property Address	5020 5050 5090 Austin Bluffs Pkwy		
City, State, Zip	Colorado Springs CO 80918		
Structure Type	<input type="checkbox"/> Main Residence <input type="checkbox"/> Secondary Residence <input type="checkbox"/> Auxiliary Structure <input checked="" type="checkbox"/> Commercial Structure		
<b>Main</b> = Primary living structure, <b>Secondary</b> = Mother in law, additional living quarters in separate structure <b>Auxiliary</b> = has wastewater disposal but no living space, <b>Commercial</b> = nonresidential use			

### Permit Inactivation

<input type="checkbox"/>	Permit Expired: System Not Installed	Permit Holder Notified:  <input type="checkbox"/> Phone Call <input type="checkbox"/> Email <input type="checkbox"/> Final Letter	Date ON Inactivated:
<input checked="" type="checkbox"/>	System Abandon/Not Located	Reason: Commercial structure (Church) connected to CSU; date unknown.	Date ON Inactivated: unk
Specialist: VP		Date Reviewed and Approved: 11.20.2024	

### Administrative Record Correction

<input type="checkbox"/>	Property Re-enumeration	New Property Address:	
		Legal Description:	New Tax Schedule #:
		Reason:	
		Comments:	
<input type="checkbox"/>	Historic Record Closure	Reason:	
		Comments:	
Specialist:		Date Reviewed:	

EL PASO COUNTY HEALTH DEPARTMENT  
COLORADO SPRINGS, COLORADO

# 2720<sup>08</sup>  
P

SEWAGE DISPOSAL INSPECTION FORM

APPROVAL:  
YES ☒ NO ☐

#6323112018

DATE 6/5/84

ENVIRONMENTALIST Krueger

LOCATION (street number: 5020 AUSTIN BLUFFS PKWY) UPANT Evangel Bible Church

LEGAL DESCRIPTION Lot 8 Block 13: Park Vista Est.

TYPE OF CONSTRUCTION Church NO. OF BEDROOMS N/A

SYSTEM INSTALLED BY Evangel Bible Church

COMMERCIAL MFG. yes SIZE 5000

TYPE OF MATERIAL STEEL NO. COMPARTMENTS 2

WIDTH \_\_\_\_\_ LENGTH \_\_\_\_\_ DEPTH (total) \_\_\_\_\_ LIQ. CAP. \_\_\_\_\_

DISPOSAL FIELD: BED OR TRENCH DEPTH 24"-36" WIDTH 36" LENGTH 392' SQ. FT. 1176

DISTANCE BETWEEN LINES \_\_\_\_\_ ROCK river DEPTH 12" UNDER 6" OVER 2"

LEACHING PITS (NO.) \_\_\_\_\_ LINING MATERIAL \_\_\_\_\_ CAPACITY SQ. FT. \_\_\_\_\_

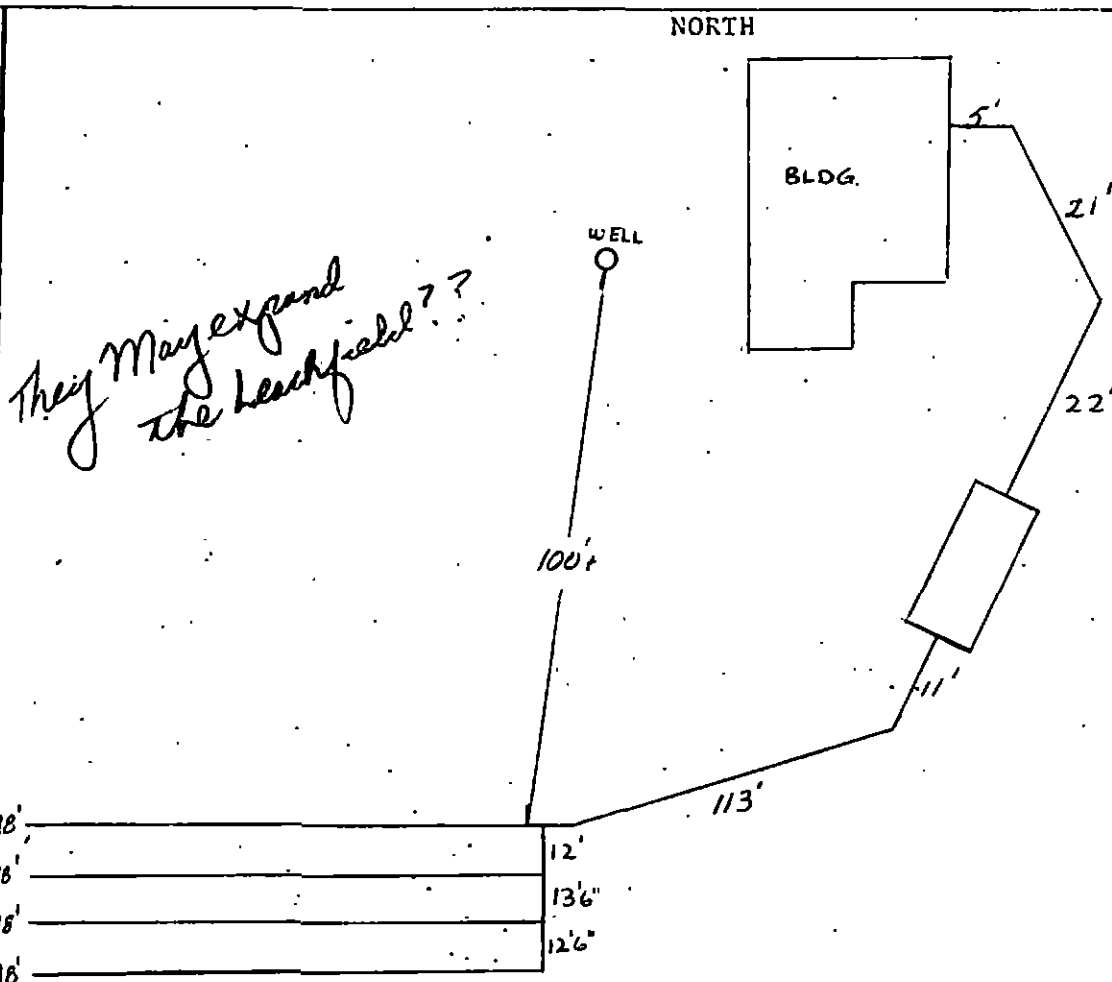

Acres \_\_\_\_\_

**EL PASO COUNTY • COUNTY HEALTH DEPARTMENT**Permit N2 2720Water Supply Well

501 North Foote Avenue • Colorado Springs, Colorado • 636-0125

**PERMIT**Receipt No. 7458**TO CONSTRUCT, ALTER, REPAIR or MODIFY ANY INDIVIDUAL SEWAGE DISPOSAL SYSTEM**Issued To Evangel Bible Church Date 5/29/84Address of Property 3030 Templeton Gap, Lot 8, Block 13, Phone \_\_\_\_\_

C.S.

(Permit valid at this address only)

5020 Austin Bluffs Drive

Sewage-Disposal System work to be performed by \_\_\_\_\_ Phone \_\_\_\_\_

This Permit is issued in accordance with 25-10-106 Colorado Revised Statutes 1973, as amended. PERMIT EXPIRES upon completion-installation of sewage-disposal system or at the end of six (6) months from date of issue — whichever occurs first — (unless work is in progress).

**— THIS PERMIT DOES NOT DENOTE APPROVAL OF ZONING AND ACREAGE REQUIREMENTS —**

\$145.00 - Fee not refundable

PERMIT FEE

DIRECTOR, CITY-COUNTY HEALTH DEPARTMENT.

[Signature]

ENVIRONMENTALIST

November 29, 1984

DATE OF EXPIRATION

**NOTE: LEAVE ENTIRE SEWAGE-DISPOSAL SYSTEM UNCOVERED FOR FINAL INSPECTION. 48 HOUR ADVANCE NOTICE REQUIRED.**

SEPTIC TANK SIZE <u>3000</u> GALLONS		TOTAL ABSORPTION AREA <u>1162</u> SQ. FT.	
TRENCH SYSTEM		BED SYSTEM	
387 ft. of trench <u>36</u> inches wide		_____ ft. x _____ ft.	
		SEEPAGE PIT SYSTEM	
		_____ rings or _____ diam. x _____ w/d	

**NOTES:** Must meet minimum distance req. Can't use old, comp septic tank from theater. O.K. per engineer design need engineer to inspect system also and submit letter. ( 4 - (97' X 3' Trenches).

The Health Office shall assume no responsibility in case of failure or inadequacy of a sewage-disposal system, beyond consulting in good faith with the property owner or representative. Free access to the property shall be authorized at reasonable times for the purpose of making such inspections as are necessary to determine compliance with requirements of this law.

Date 8/16/83

EL PASO COUNTY HEALTH DEPARTMENT  
501 NORTH FOOTE AVENUE  
COLORADO SPRINGS, COLORADO  
636-0125

TAX SCHEDULE # \_\_\_\_\_

Application for permit to construct, Remodel, or Install a Sewage Disposal System.

Name of Owner Evangel Bible Church Phone \_\_\_\_\_

Address of Property 5040 Templeton Gap 5020 Austin Bluffs Pkwy

Legal Description of Property Lot 3 Block 13

Owner's Address (if different) \_\_\_\_\_ Phone \_\_\_\_\_

Systems Contractor \_\_\_\_\_ Address \_\_\_\_\_

Type of Construction Church source and type  
of water supply WELL

Size of Lot \_\_\_\_\_

The construction of the Sewage Disposal System will comply with all applicable Laws, Ordinances, Standards or Resolutions.

HEALTH DEPARTMENT USE ONLY

Permit Number \_\_\_\_\_ Receipt Number \_\_\_\_\_

Number of Bedrooms N/A Tank Capacity 3000 gallons Absorption area 1162 Sq. Ft.

Remarks CONV. E. ENGINEER SITE OK. WILL DESIGN SYSTEM (JOE GOODE; ROCKY MOUNTAIN GEOTECHNICAL) MUST MEET MINIMUM DISTANCE REQUIREMENTS

Can't use old 1 comp septic tank from theater OK per  
APPLICATION IS ( ) APPROVED ( ) DENIED engineer design

ENVIRONMENTALIST Langer DATE 8/16 19 83

PLOT PLAN WILL INCLUDE THE FOLLOWING

Plot plan may be drawn on the back of this sheet or on a separate sheet.

1. Streams, Lakes, Ponds, Irrigation Ditches and other Water Courses
2. North Direction
3. Location of Property Line
4. Buildings
5. Wells
6. Location of Proposed Septic System
7. Location of percolation test
8. Geographical features
9. Other Information as required

387' x 3' french

4 (97' x 3' frenches)

**BP**

**E**

#6323112018 06/05/1984

5020 AUSTIN BLUFFS PKWY

August 9, 1983

El Paso County Health Department  
501 N. Foote  
Colorado Springs, CO 80909

Dear Sirs:

Commercial Builders of Kansas has hired Rocky Mountain Geotechnical to do a percolation test, soil profile and to calculate the septic system at the Evangel Church at 5090 Templeton Gap, Colorado Springs, CO.

The name of the engineer in charge is Joseph C. Goode. His phone is 634-1999.

If I can be of further help, please contact me.

Sincerely,



Bill Peters  
Commercial Builders of KS  
Superintendent  
598-2705

cp/BP



## EL PASO COUNTY HEALTH DEPARTMENT

501 NORTH FOOTE AVENUE • COLORADO SPRINGS, CO 80909-4598

AIR QUALITY CONTROL: 501 NORTH FOOTE, 80909-4598 • 636-0137  
CODE ENFORCEMENT: 105 EAST VERMIJO, SUITE 350, 80903 • 471-6878  
DRUG TREATMENT PROGRAM: 710 SOUTH TEJON, 80903 • 636-0150  
VITAL STATISTICS: 27 EAST VERMIJO, 80903 • 471-5762

REPLY TO:

August 16, 1983

Re: Evangel Church  
5090 Templeton Gap Road  
Colorado Springs, Colorado

To Whom It May Concern:

The Health Department does not object to a building permit being issued for the above mentioned property.

Discussion with the engineer (Joe Goode, Rocky Mountain Geotechnical) indicated percolation test is satisfactory, and site is okay also.

If you have any questions, please feel free to call.

Sincerely,

Gary Krueger  
Environmentalist  
Environmental Health Services  
636-0132

GK:smm

CONV. & MR. PERRY -

TOLD HIM TO CHECK WITH  
LAND USE.

VERBAL CONV. IN OFFICE

8/17/83 A.M.

CITY OF COLORADO SPRINGS

COLORADO 80947

P.O. BOX 1193

DEPARTMENT OF PUBLIC UTILITIES  
WATER—ELECTRIC—GAS—WASTE WATER  
Land Office  
(303)636-5380

UTILITIES BUILDING  
18 S. NEVADA AVE.

September 1, 1982

Mr. M. Lemuel Perry  
Evangel Bible Church  
5090 Templeton Gap Road  
Colorado Springs, CO 80918

Dear Mr. Perry:

In reference to your request for vacation of the lot line between Lots 7 and 8, Block 13, Park Vista Estates Subdivision, this is to inform you that the Department of Public Utilities, City of Colorado Springs has no objection to the subject vacation.

Sincerely,

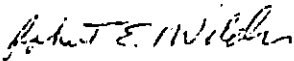

ROBERT E. WILDER  
City Land Office Representative

REW:lh

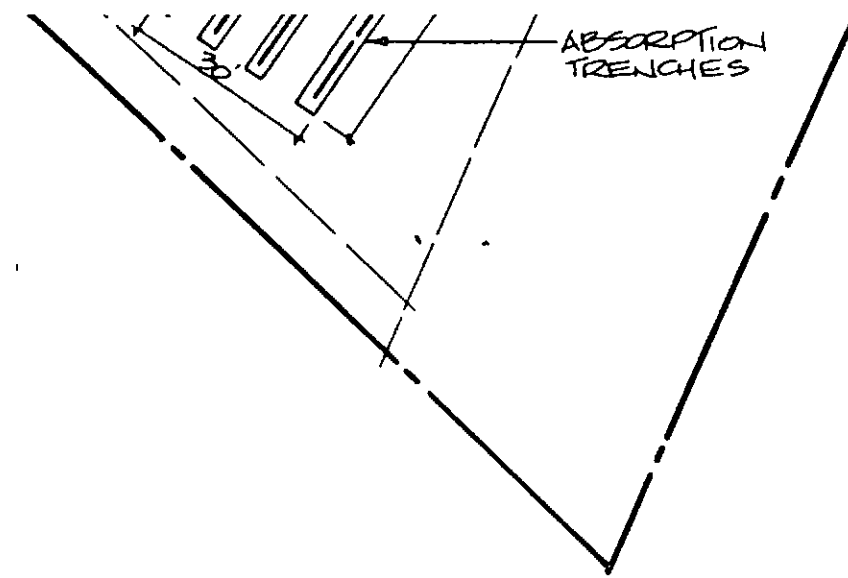

PLAN LOCATION  
SCALE: 1" = 30'

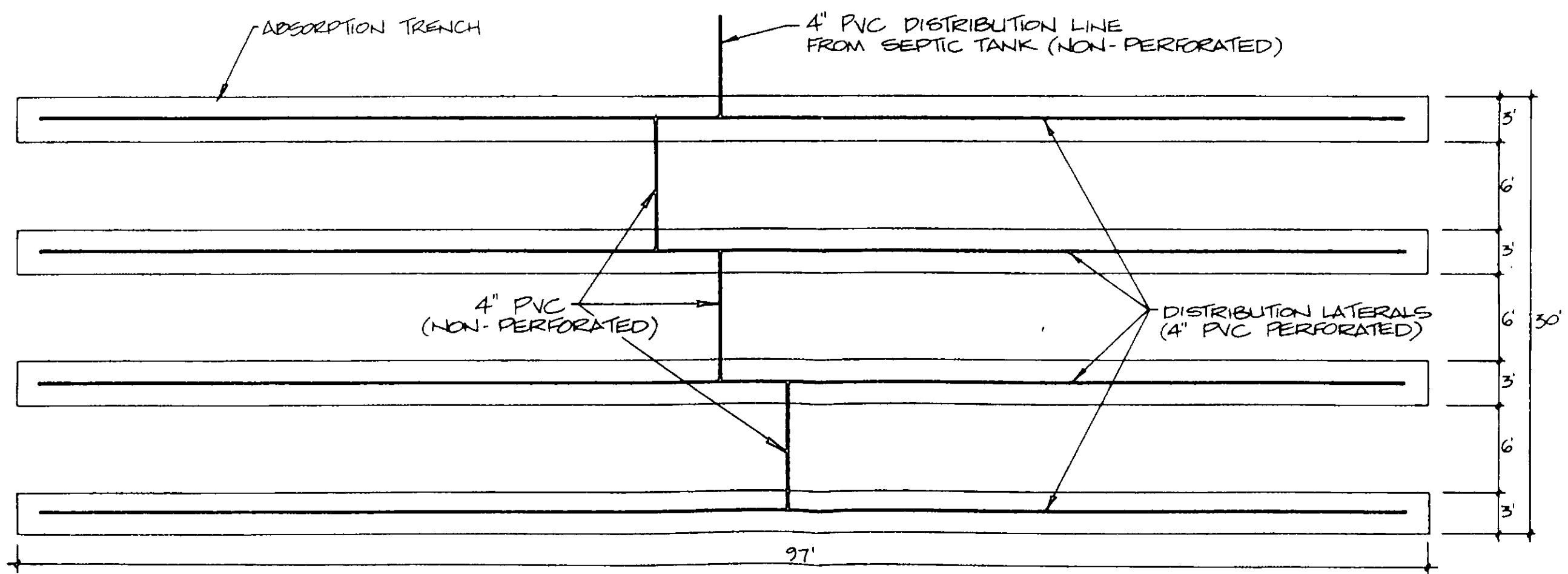

DISTRIBUTION MANIFOLD PLAN  
SCALE: 1/8" = 1'-0"



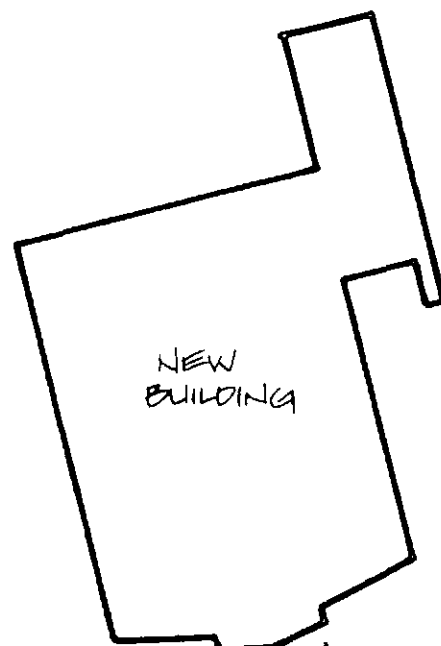

SEPTIC TANK -  
3000 GAL.  
CAPACITY



10' MIN.

PARKING

PARKING

TEMPLETON GAP ROAD

45' EASEMENT

EASEMENT

DISTRIBUTION  
LATERALS

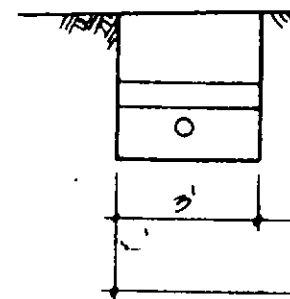
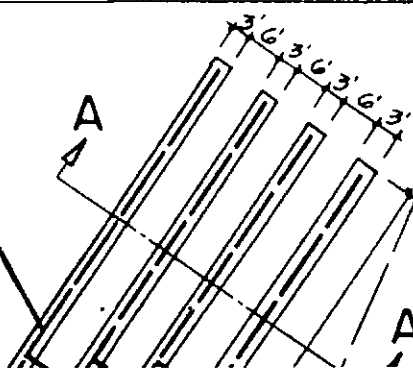

LETON GAP ROAD

DESIGN DATA

- Type of Sewage System
- Average Total Maximum
- Percolation
- Soil Permeability
- Required
- Septic

CONSTRUCTION

- The same lateral distribution. Either
- All except shall

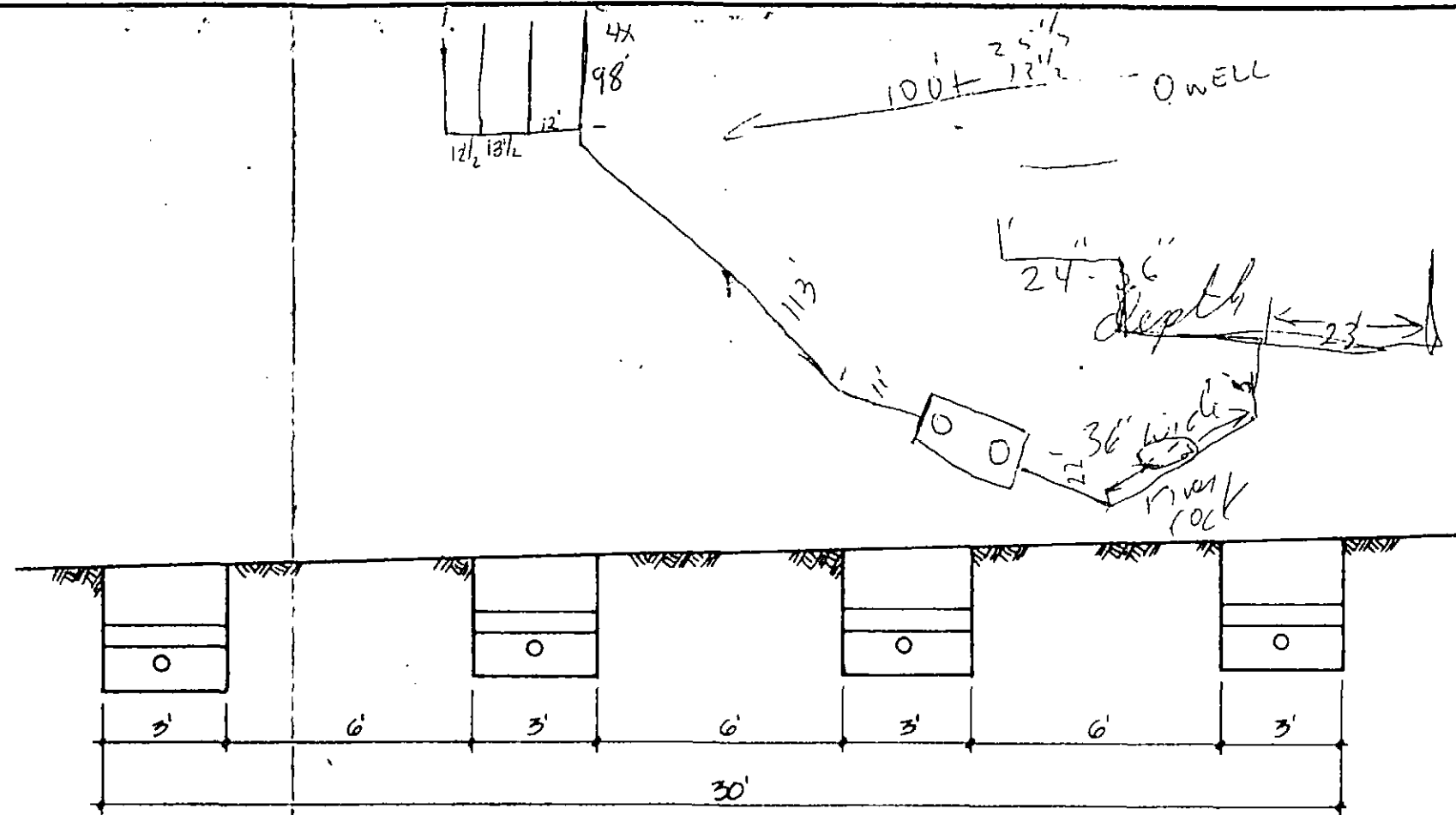

SECTION A-A  
ABSORPTION TRENCH SYSTEM CROSS-SECTION  
SCALE:  $\frac{1}{4}'' = 1'-0''$

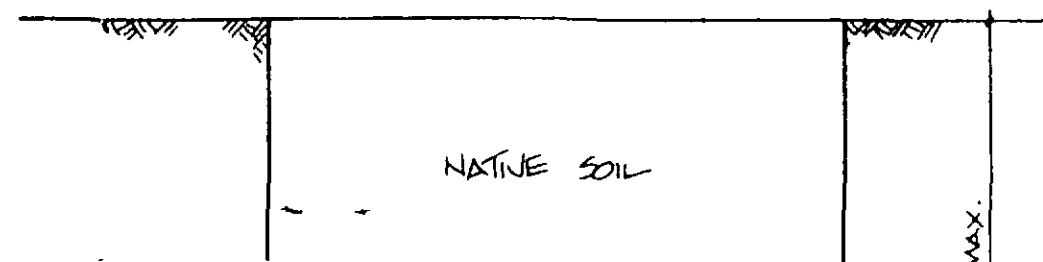

**DESIGN DATA**

- o Type of
- o Sewage  
System

Average  
Total  
Maximum

- o Percola

**A1**

SOIL PI

0 - 4<sup>th</sup>

4<sup>a</sup> - 9<sup>a</sup>

- o **Require**

- Septic

**CONSTRUCT:**

1. The same later later distr Either

2. All  
except  
shall

LETON GAP RD

Septic

CONSTRUCT

1. The same later later distr Eithe
2. All excep shall
3. Inlet fall of c dista the s
4. Septi Healt

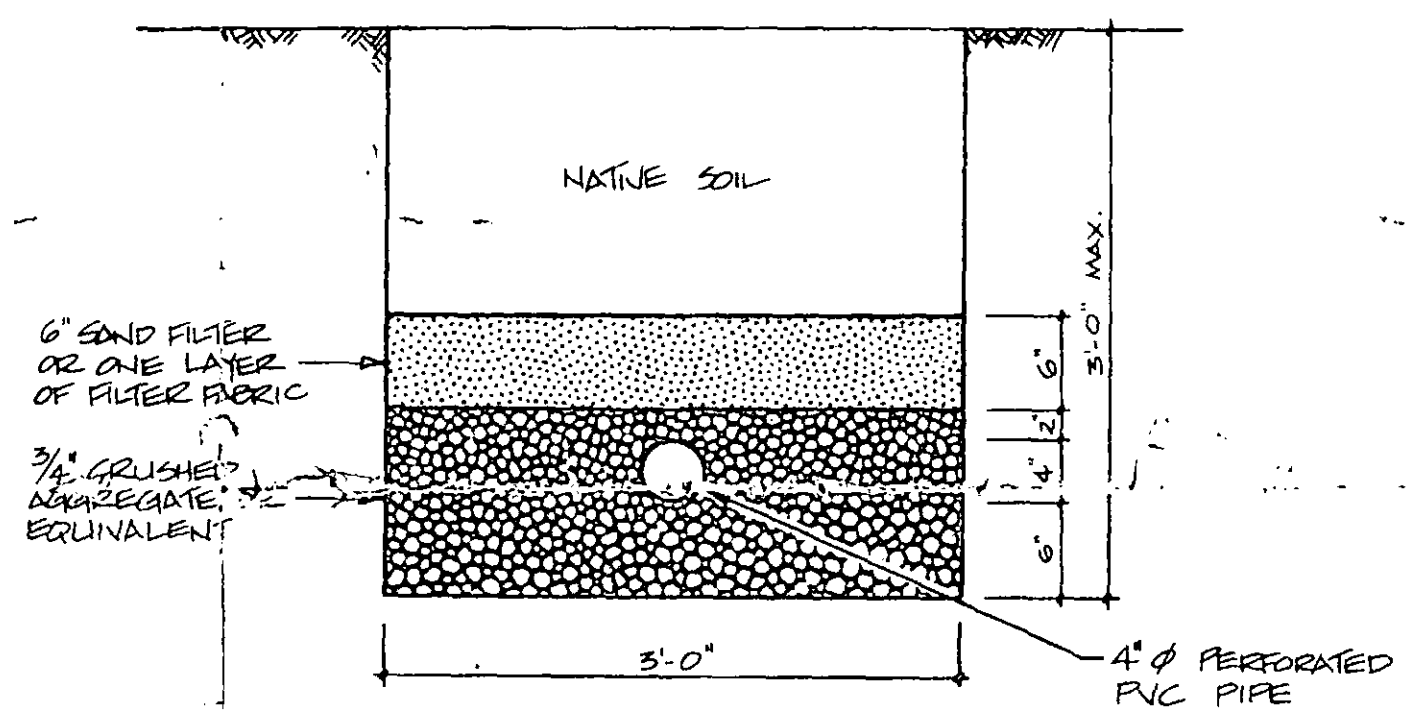

ABSORPTION TRENCH CROSS-SECTION  
SCALE: 1" = 1'-0"

DISTRIBUTION LINE  
TIC TANK (NON-PERFORATED)

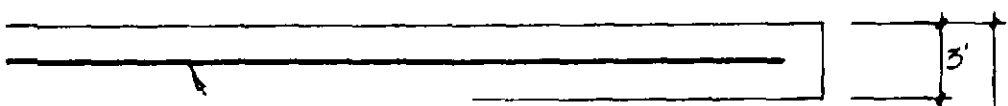

DESIGN DATA

- Type of facility - church - 200 seat capacity
- Sewage volume (Ref: El Paso County Individual Sewage Disposal System Regulations 1980)
  - Average Flow = 5 gal/seat/day
  - Total Average Flow = 200 x 5 gal/seat/day = 1000 gal/day
  - Maximum Flow = 1.5 x average flow = 1500 gal/day
- Percolation Test Results (8/12/83)

HOLE	PERCOLATION RATE
	MIN/IN
	10.4
	9.6
	25.3
Average	15 min/in

SOIL PROFILE

Slope of site mild.

- 0 - 4" Topsoil No groundwater encountered.
- 4" - 9' Fine clayey sand Bedrock not encountered.

Required Trench Area

$$A = \frac{Q \sqrt{t}}{5} = \frac{1500 \sqrt{15}}{5} = 1162 \text{ ft}^2$$
  
 $Q = \text{sewage flow (gal/day)}$   
 $t = \text{percolation rate (min/in)}$   
 $A = \text{area (ft}^2\text{)}$   
Assuming 3-foot wide trenches  
$$\text{Total trench length} = \frac{1162 \text{ ft}^2}{3} = 387 \text{ l.ft.}$$
  
Use four 97-foot trenches

Septic tank size - 1500 gal/day x 2 days = 3000 gal.

CONSTRUCTION NOTES - ABSORPTION TRENCHES:

- The absorption trench lines may all be constructed at the same elevation, if desired. In this case, the distribution laterals must be level. However, if the three distribution laterals are terraced on the slope, then a relief line distribution network will be required between the trenches. Either method would be suitable for this site.
- All pipe shall consist of 4"  $\phi$  non-perforated PVC pipe, except in absorption trenches, where 4"  $\phi$  perforated PVC pipe shall be used.
- Inlet and outlet pipes for septic tank must have a minimum fall of 1/8" per foot. Inlet and outlet pipes must consist of cast iron pipe or pipe of equivalent strength for a distance of at least 5 feet from the inlet and outlet ends of the septic tank.
- Septic tank construction shall comply with El Paso County Health Department Regulations.

Job No.  
2020/  
23553

Fig. No.

SEPTIC SYSTEM DESIGN

EVANGEL BIBLE CHURCH  
5090 TEMPLETON GAP ROAD  
COLORADO SPRINGS, COLORADO

Drawn  
UAB

Date  
8-24-83

Checked  
JCG

Date  
9-2-83

MOUNTAIN  
NICAL, INC.  
nony with Earth

P

#720

DISPOSAL 1  
66

Date of Insp. JULY 1, 1969  
Sanitarian KRUEGER

(Septic Tank)

Type of material PRE CAST CONCRETE No.            Compartments             
Width            Length            Depth (eff)             
Depth (Total)            Liquid capacity 1500 Gallons

Leaching Pits (No.) \_\_\_\_\_ Soil \_\_\_\_\_ Perc. Test \_\_\_\_\_  
Lining Material \_\_\_\_\_ Capacity in Gallons \_\_\_\_\_  
Diam. \_\_\_\_\_ Depth \_\_\_\_\_

Disposal Field 60 x 20 Soil CLAY, SANDY Perc. Test 3.3 min/inch  
Total Length of tile lines \_\_\_\_\_ Number of lines \_\_\_\_\_  
Distance between lines \_\_\_\_\_ Length of each line \_\_\_\_\_ Absorb. Area 1200'  
Type of tile BITUMINOUS Trench Depth \_\_\_\_\_ Trench Width \_\_\_\_\_ Grade < 1/16"  
Type Filter Material peg gravel Depth: Under Tile 12" Over Tile 2"

Cesspool: \_\_\_\_\_ Soil \_\_\_\_\_  
Lining Material \_\_\_\_\_ Diam. \_\_\_\_\_ Depth (effl.) \_\_\_\_\_ Cap. \_\_\_\_\_

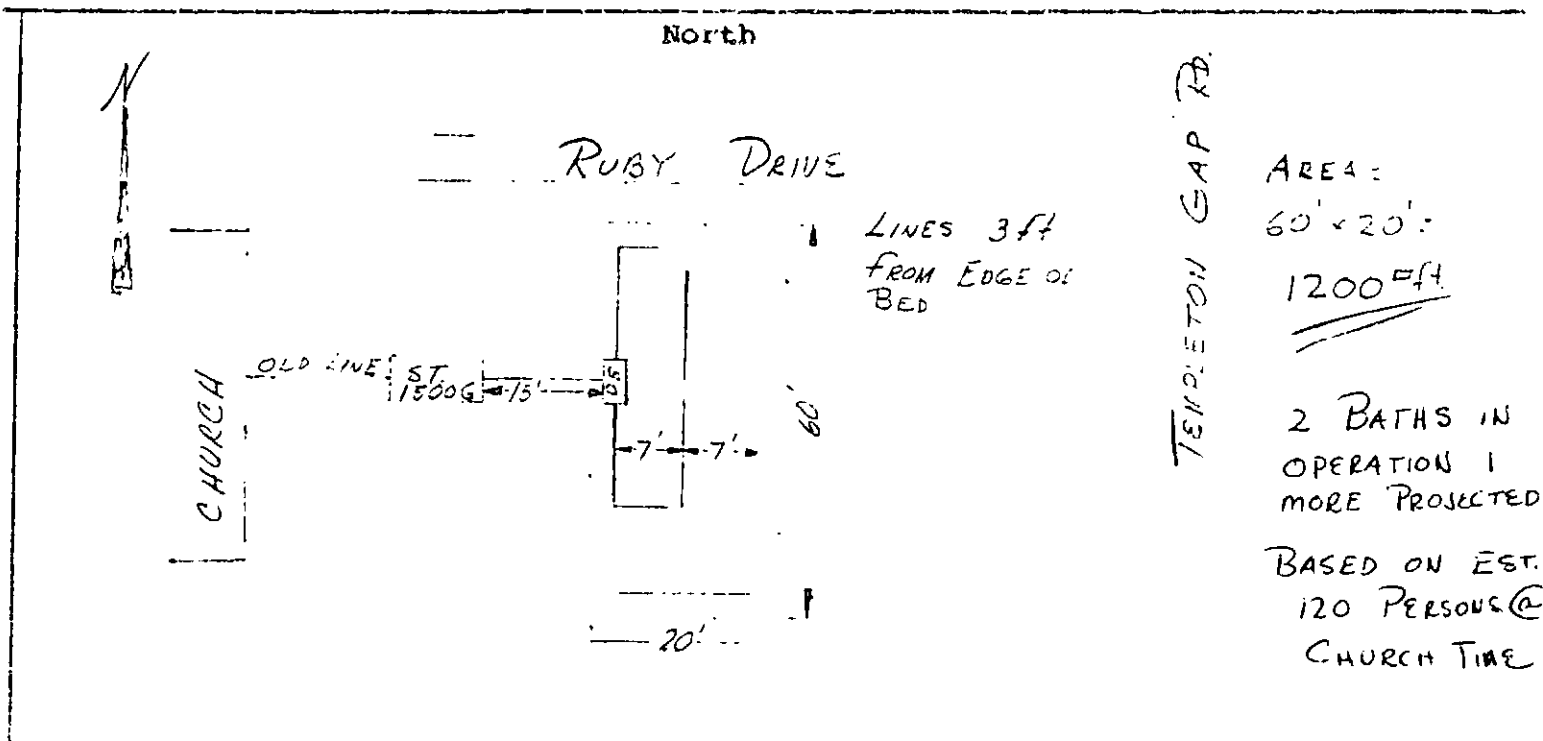

RUBY DR.

190'

405' 70  
Tangle & etc. 246

North

PROPOSED

39'

X WELL

EXISTING

NEW BLDG.

X 51945 8  
PT 1  
18  
10

217'

286'

29'

160.86'

Evangelical Church

Lot 10 Block 13  
East Union Exh. Co.

# CITY-COUNTY HEALTH DEPARTMENT

Colorado Springs Colorado El Paso County

## PERMIT

Individual Sewage Disposal System (Construction, Alteration or Repair)

Issued To Edward B. Binkley Date 6-6-67

Address of Property Lot 10, Block 13 - Park Vista Estates  
(Permit valid at this address only)

Builder - Contractor - Owner—Address Strom Phone \_\_\_\_\_

Sewage-Disposal System work to be performed by Richard Phone \_\_\_\_\_

This Permit is issued in accordance with Regulation XII and Article 2 of Chapter 66, Colorado Revised Statutes 1963, as amended by the addition of a new Section 66-2-16. (H.B. 1205, 7-1-65). **PERMIT EXPIRES** upon completion—installation of sewage-disposal system or at the end of six (6) months from date of issue—whichever occurs first (unless work is in progress).

Dec. 16 1967  
(Date of Expiration)

R. K. Miller, M. D.  
Director, City-County Health Dept.

Permit Fee \$ 5.00  
 Mileage (8c/mile to and from site) 10 .80  
 Total Fee \$5.80

**NOTE: Leave entire sewage-disposal system uncovered for final inspection.**

24-hour advance notice required.

Septic tank 1500 gals. Field 300 feet of trench 36 inches wide.  
(11 1/2 x 200 ft) 10 1/2 ft. long 360 ft. wide. Seepage pit \_\_\_\_\_ gallons.

The Health Officer shall assume no responsibility in case of failure or inadequacy of a sewage-disposal system, beyond consulting in good faith with the property owner or representative.

4343

3a ±  
Well

No 720

(OVER)

6/13/69 - E Rev. Geist on phone - requested to go  
the bed route, not field. Told to go to 11-1200 a' bed.



10 @

580  
580

#6323112018

07/01/1969

5020 AUSTIN BLUFFS PKWY

# SOIL PERCOLATION TESTS FIELD DATA SHEET

CLIENT Evangelical Bible Church

TEST NO. 9878

TEST LOCATION 1709 Ruby Drive

DATE June 6, 1969

TRIAL NO.	DEPTH START, IN	START TIME	DEPTH FINISH, IN	FINISH TIME	TOTAL DROP INCHES	TOTAL DROP TIME, MIN.	MINUTES TO DROP 1 INCH
1	24"	1450	27"	1500	3	10	3.3
2							
3							
4							
5							

## SOIL LOG

FROM	TO	SOIL CLASSIFICATION	MOISTURE
0'	5'	clayey sand silty sand, lean, sandy	moderate
5'	8'	Dawsbn Formation - very dense	low
8'		Refusal	

1500 gallons S.T.

900' - 1.3  
FHA-1103-7.3 3.5  
LEACHING FIELD 300' 360' L ft

FHA-1103-8.5

SEEPAGE PIT

REQUIRED AREA OF TRENCH BOTTOM

REQUIRED SIDEWALL AREA

PER BEDROOM 300 50 FT. total

PER BEDROOM SQ. FT.

REMARKS: 2 baths now in operation - one more projected. I family in residence, estimated 120 persons at church time

DATE HOLE SATURATED 6-4-69 TIME 1030

DATE PERCOLATION TEST MADE 6-5-69 TIME 1500

PH  
OBSERVER

PROFESSIONAL ENGINEER

LINCOLN DeVORE TESTING LABORATORY  
Colorado Springs, Colorado