

0100035790

EL PASO COUNTY DEPARTMENT OF HEALTH AND ENVIRONMENT
INDIVIDUAL SEWAGE DISPOSAL SYSTEM INSPECTION FORM

Permit # 8481
Date 1-10-95

APPROVED: YES NO #5302001007 ENVIRONMENTALIST R. Griffen
Address 8025 Falcon Meadows Owner Golden Eagles Homes

Legal Description Lot 11 Filing #1
Residence , # of bedrooms _____; Commercial _____; System Installer D+B

SEPTIC TANK:
Commercial _____; Noncommercial , L _____, W _____, WD _____
Construction Material 2 comp concrete precast, capacity 1250 gallons.

DISPOSAL FIELD:
Rock Systems:
Trench: depth _____, width _____, total length _____, sq. feet _____
Bed: depth _____, length _____, width _____, sq. feet _____
Rock type _____, depth _____, under PVC _____, over PVC _____
Seepage Pits: # of pits _____, total # of rings _____, working depth(s) _____
size of pit(s) L X W _____, lining material _____, total sq. feet _____

Rockless Systems:
Chamber: Type Infiltrator, number of chambers 15, bed _____, trench
sq. ft./section 18, reduction allowed 30%, sq. ft. required 331
total sq. ft. installed 540, depth of installation _____

Engineer Design Y or (N) Designing Engineer _____
Approval letter provided? Y or (N)
Well 50 feet from tank (Y) or N 100 feet from leach field (Y) or N
Well installed at time of septic system inspection (Y) or N Public Water _____
*Approval will be revoked if in the future the well is found to be within 50 feet of the septic tank and/or 100 feet of the disposal field.

NOTES:

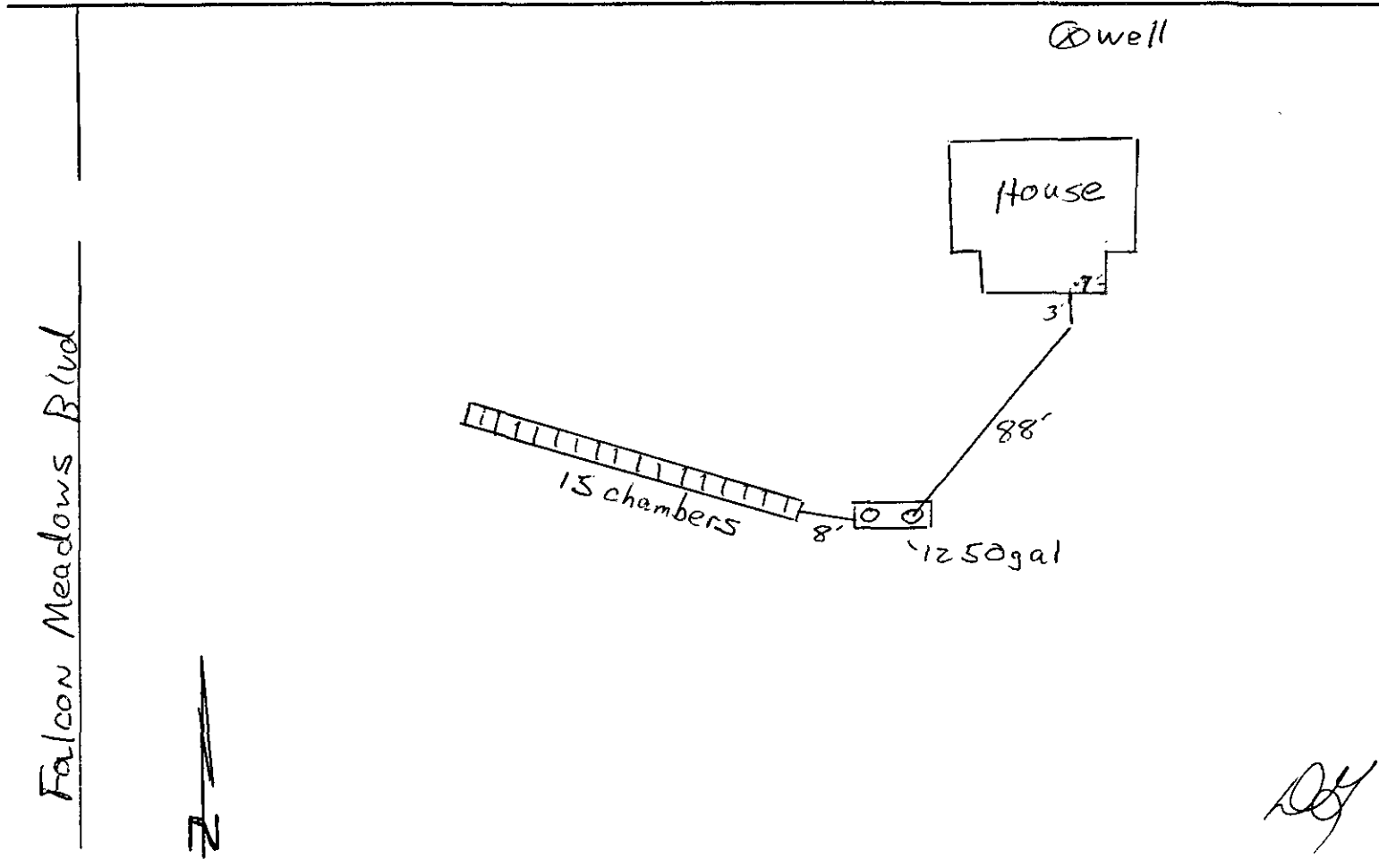

Acres 5 **EL PASO COUNTY • DEPARTMENT OF HEALTH AND ENVIRONMENT** Permit UT
 Water Supply WELL 301 South Union Blvd. • Colorado Springs, Colorado • 578-3125 Receipt No. 5489

PERMIT

TO CONSTRUCT, ALTER, REPAIR OR MODIFY ANY INDIVIDUAL SEWAGE DISPOSAL SYSTEM

8481

Issued to GOLDEN EAGLE HOMES, LTD. Date 9-19-94

Address of Property 8025 FALCON MEADOWS, LOT 11, THE MEADOWS Phone RANDY: 598-8573
(Permit valid at this address only)

Sewage-Disposal System work to be performed by D. & B. Trenching Brier FILING #1 Phone 683-2400

This Permit is issued in accordance with 25-10-106 Colorado Revised Statutes 1973, as amended. PERMIT EXPIRES upon completion of installation of sewage-disposal system or at the end of twelve (12) months from date of issue—whichever occurs first—(unless work is in progress). This permit is revokable if all stated requirements are not met.

-THIS PERMIT DOES NOT DENOTE APPROVAL OF ZONING AND ACREAGE REQUIREMENTS-

\$150.00
 PERMIT FEE (NOT REFUNDABLE)

[Signature]
 DIRECTOR, DEPARTMENT OF HEALTH AND ENVIRONMENT

9-19-95
 DATE OF EXPIRATION

[Signature]
 ENVIRONMENTALIST

NOTE: LEAVE ENTIRE SEWAGE-DISPOSAL SYSTEM UNCOVERED FOR FINAL INSPECTION. 48 HOUR ADVANCE NOTICE REQUIRED.

SEPTIC TANK: total square feet _____ 1250 gallons	TRENCH SYSTEM: total square feet <u>331</u> _____ ft. of trench _____ inches wide _____ ft. of trench _____ inches wide	BED SYSTEM: total square feet _____	SEEPAGE PIT SYSTEM: total square feet _____ rings or _____ diam.x _____ w/d
---	--	--	---

NOTES: SYSTEM TO BE INSTALLED PER REGULATIONS.

The Health Office shall assume no responsibility in case of failure or inadequacy of a sewage-disposal system, beyond consulting in good faith with the property owner or representative. Free access to the property shall be authorized at reasonable time for the purpose of making such inspections as are necessary to determine compliance with requirements of this law.

New

Kandy

Plot

APPLICATION FOR A PERMIT TO CONSTRUCT, REMODEL, OR INSTALL A SEWAGE DISPOSAL SYSTEM

NAME OF OWNER GOLDEN EAGLE HOMES, LTD HOME PHONE _____ WORK PHONE 598-8573

ADDRESS OF PROPERTY 8025 FALCON MEADOWS #1 DATE 9/12/94

LEGAL DESCRIPTION OF PROPERTY LOT 11, THE MEADOWS FILING 1

TAX SCHEDULE NUMBER 53020-01-007 SYSTEM CONTRACTOR D-B TRENCHING PHONE 683-2400

OWNER'S ADDRESS IF DIFFERENT N/A

TYPE OF HOUSE CONSTRUCTION FRAME - 2 STORY SOURCE AND TYPE OF WATER SUPPLY WELL

SIZE OF LOT 5 ACRES MAXIMUM POTENTIAL NUMBER OF BEDROOMS 3 BASEMENT (yes or no)

PERCOLATION TEST RESULTS ATTACHED (yes or no)

A plot plan and accompanying information are essential; it may be drawn on the back of this application or be attached. Please include by measured distance the location of wells including neighbors' wells, springs, water supply lines, cisterns, buildings, proposed structures, property lines, property dimensions, subsoil drains, lakes, ponds, water courses, streams, and dry gulches. Please show the location of the proposed septic system by directions and distances from actual and/or proposed dwellings, structures, or fixed reference objects. Give complete directions to the property from major highways. (ANSWER QUESTIONS ON BACK OF FORM).

Applicant acknowledges that the completeness of the application is conditional upon such further mandatory and additional tests and reports as may be required by the department to be made and furnished by the applicant for purposes of evaluation of the application; and issuance of the permit is subject to such terms and conditions as deemed necessary to ensure compliance with rules and regulations adopted under Article 10, Title 25, C.R.S. 1973; as amended. The undersigned hereby certifies that all statements made, information and reports submitted by the applicant are or will be represented to be true and correct to the best of my knowledge and belief and are designed to be relied on by the El Paso County Health Dept. in evaluating the same for purposes of issuing the permit applied for herein. I further understand that any falsification or misrepresentation may result in the denial of the application or revocation of any permit granted based upon said application and in legal action for perjury as provided by law.

Golden Eagle Homes, Ltd
SIGNATURE Cardall L Reming, President

HEALTH DEPARTMENT USE ONLY

PERMIT NUMBER 8481 RECEIPT NUMBER 5487 DATE TO LAND USE DEPARTMENT attached (OK)

ABSORPTION AREA 3310 ft² TANK CAPACITY 1250 gal DATE OF SITE INSPECTION 9-13-94

REMARKS: System to be installed per regulations

APPLICATION IS APPROVED () DENIED () DATE 9/13/94 ENVIRONMENTALIST J. Malowski, D

ANSWER THE FOLLOWING ITEMS AND/OR INCLUDE ON PLOT PLAN.

- PROPERTY LINES Plot Plan
- PROPERTY DIMENSIONS " "
- LOCATION OF PROPOSED SEPTIC SYSTEM " "
- LOCATION OF WELL " "
- LOCATION OF ADJACENT WELLS N/A
- BUILDINGS Plot Plan
- PROPOSED BUILDINGS N/A
- WATER SUPPLY LINE N/A
- CISTERNS N/A
- SPRINGS N/A
- LAKES N/A
- PONDS N/A
- WATER COURSES N/A
- STREAMS N/A
- DRY GULCHES N/A
- SUBSOIL DRAINS N/A

DIRECTIONS TO PROPERTY FROM MAIN HIGHWAYS:

Woodmen Road East to Falcon Meadows Blvd N to Site