

EL PASO COUNTY DEPARTMENT OF HEALTH AND ENVIRONMENT
INDIVIDUAL SEWAGE DISPOSAL SYSTEM INSPECTION FORM

Permit # DN0002162
Date 11/30/00 and 12/20/00

APPROVED: YES NO # 5232303001

ENVIRONMENTALIST Ginger Glenn

Address 6825 Silver Ponds Heights Building 1 Owner Silver Office Park

Legal Description Lot 25, Silver Ponds Subdivision, Filling #1
Residence # of bedrooms ; Commercial ; System Installer Tank K

SEPTIC TANK:
Commercial ; Noncommercial L W WD Excavating
Construction Material precast concrete capacity (1) 2250 gallons.
(2) 1000

DISPOSAL FIELD:
Rock Systems: per PE design.
Trench: depth width total length sq. feet
Bed: depth length width sq. feet
Rock type depth under PVC over PVC
Seepage Pits: # of pits total # of rings working depth(s)
size of pit(s) L X W lining material total sq. feet

Rockless Systems:
Chamber: Type number of chambers bed trench
sq. ft./section reduction allowed % sq. ft. required
total sq. ft. installed depth of installation
Engineer Design or N Designing Engineer Michael Reynolds
Approval letter provided? or N 3/12/01
Well 50 feet from tank or N 100 feet from leach field or N
Well installed at time of septic system inspection or N Public Water
*Approval will be revoked if in the future the well is found to be within 50 feet of the septic tank and/or 100 feet of the disposal field.

NOTES:
Drawing not to scale.
Sch 40 used for tank to tank connections.

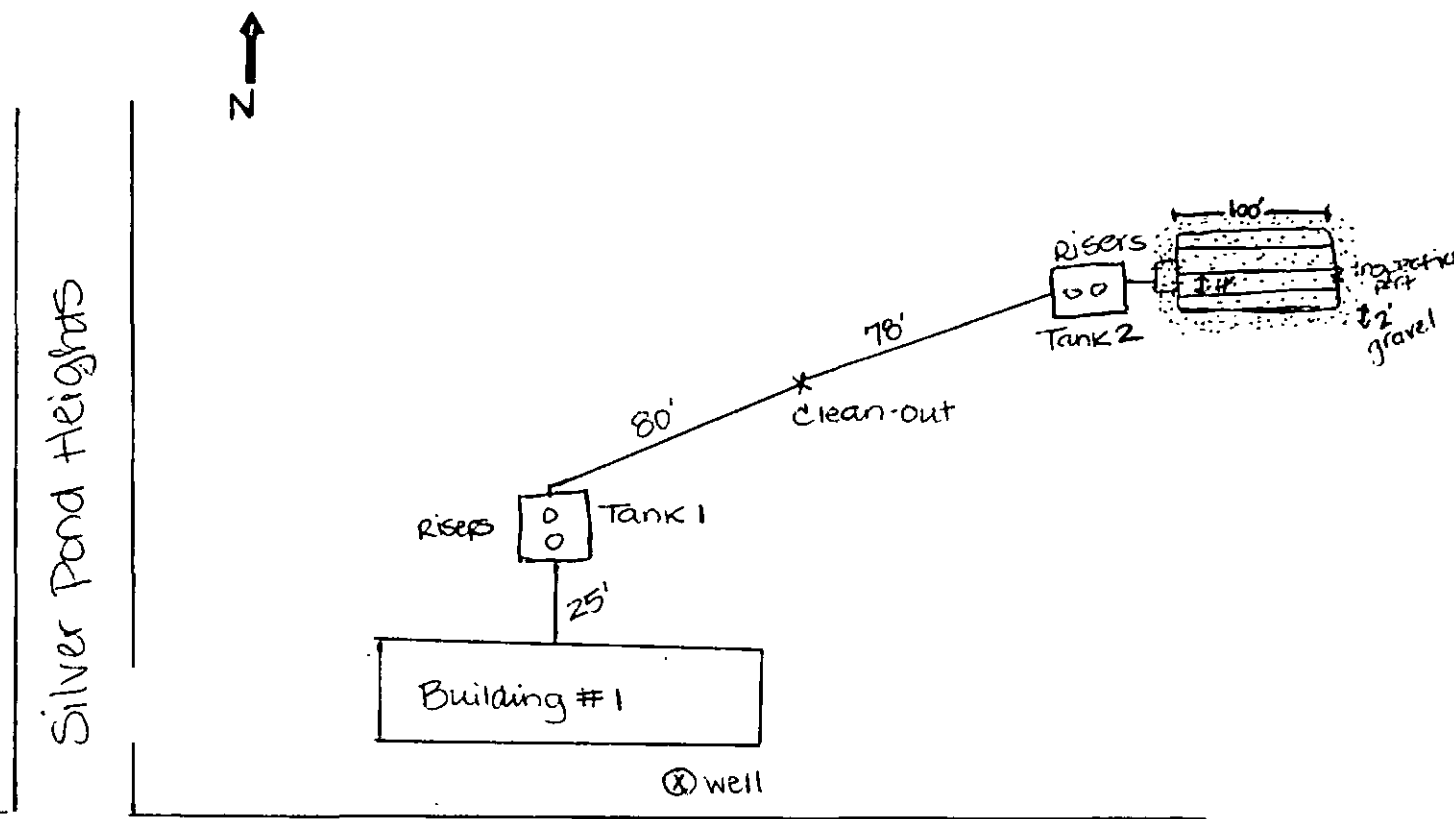

Black Forest Rd.

EL PASO COUNTY

DEPARTMENT OF HEALTH AND ENVIRONMENT
301 S Union Blvd, Colorado Springs, Colorado 719-578-3126

INDIVIDUAL SEWAGE DISPOSAL SYSTEM PERMIT

WATER SOURCE: WELL

PERMIT NUMBER: ON0002162

OWNER NAME: SILVER OFFICE PARK
ADDRESS: 6825 SILVER PONDS HGTS
CITY, STATE, ZIP: BLACK FOREST 80908

DATE PERMITTED: 7/14/00

PHONE NUMBER: 7194818750

INSTALLED BY: WESTFALL, JOHN (J & K EXCAVATING)

This permit is issued in accordance with 25-10-107 Colorado Revised Statutes. PERMIT EXPIRES upon completion-installation of sewage-disposal system or at the end of twelve (12) months from date of issue- whichever occurs first-(unless work is in progress). If both a building and an ISDS permit are issued for the same property, and construction has not commenced prior to the expiration date of the building permit, the ISDS permit shall expire at the same time as the building permit. This permit is revokable if all stated requirements are not met. Sewage disposal system to be installed by an El Paso County Licensed System Contractor or the property owner.

THIS PERMIT DOES NOT DENOTE APPROVAL OF ZONING AND ACREAGE REQUIREMENTS.

Jisha Dower

PERMIT FEE (NON REFUNDABLE):

New Permit----\$ 300.00

ISDS Repair -\$ 50.00

Voided/Altered permit -\$ 25.00

DIRECTOR, EL PASO COUNTY DEPARTMENT OF HEALTH AND ENVIRONMENT

PERMIT EXPIRATION DATE:

Expires twelve months from date of issue

A. Triplett EHS for Janet Christensen
ENVIRONMENTALIST / PHONE NUMBER

NOTE: LEAVE THE ENTIRE SEWAGE DISPOSAL SYSTEM UNCOVERED FOR FINAL INSPECTION, 48 HOUR ADVANCE NOTICE REQUIRED.

MINIMUM SEPTIC TANK SIZE *PE Design* GALLONS

MINIMUM ABSORPTION AREA REQUIRED *PE design* SQ FT

PLANNING DEPARTMENT

ENUMERATION

FLOOD PLAIN

WASTEWATER

COMMENTS:

INSTALL ABSORPTION SYSTEM PER P.E. DESIGN IN AREA OF SOIL PERCOLATION TEST. THE SYSTEM MUST BE INSPECTED PRIOR TO BACKFILL BY THE HEALTH DEPARTMENT AND A LETTER CERTIFYING THE SYSTEM WAS PROPERLY INSTALLED PER THE ENGINEER DESIGN MUST BE RECEIVED BY THIS OFFICE BEFORE FINAL APPROVAL MAY BE GRANTED.

The Health Office shall assume no responsibility in case of failure or inadequacy of a sewage-disposal system, beyond consulting in good faith with the property owner or representative. Free access to the property shall be authorized at reasonable time for the purpose of making such inspections as are necessary to determine compliance with requirements of this law.

MAILED
CALLED 7/4

Inspector _____

Record I.D. 2162

EL PASO COUNTY ENVIRONMENTAL HEALTH SERVICES

301 South Union Boulevard • Colorado Springs, CO • 80910-3123 • (719) 578-3126

APPLICATION FOR A NEW REMODEL REPAIR OR ADDITION
TO AN INDIVIDUAL SEWAGE DISPOSAL SYSTEM P.E. DESIGN

Owner SILVER OFFICE PARK Daytime Phone 481-8750

Address of Property 6825 SILVER PONDS HEIGHTS City & Zip BLACK FOREST

Legal Description LOT 25, SILVER PONDS SUB, FILING #1

Tax Schedule # 52323-03-001 Lot Size 3.18 AC Septic Contractor J&K EXCAV.

Inside City Limits No Yes-City _____ Water Supply Well or Spring Cistern Public

Type of Building Frame Modular Mobile Commercial Manufactured Other _____

Owner's MAILING Address 19890 PINE DR. City, State & Zip MONUMENT CO 80132

MAIL PERMIT OR PICK UP PERMIT THERE IS AN ADDITIONAL RESIDENCE ON THIS PROPERTY

MAXIMUM POTENTIAL BEDROOMS <u>0</u>			
Percolation Test Attached <input checked="" type="checkbox"/> Y <input type="checkbox"/> N	Garbage Disposal Y <input checked="" type="checkbox"/> N	Basement Y <input checked="" type="checkbox"/> N	Clothes Washer Y <input checked="" type="checkbox"/> N

I have supplied a plot plan as described on the back of this form. I acknowledge the completeness of the application is conditional upon such further mandatory and additional tests and reports as may be required by the Department to be made and furnished by an applicant for purposes of evaluating the application, and issuance of the permit is subject to such terms and conditions as deemed necessary to ensure compliance with rules and regulations adopted pursuant to C.R.S. 25-10-107 et. seq. I hereby certify all represented to be true and correct to the best of my knowledge and belief, and are designed to be relied on by the El Paso County Department of Health and Environment in evaluating the same for purposes of issuing the permit applied for herein. I further understand any falsification or misrepresentation may result in the denial of the application or revocation of any permit granted based upon said application and in legal action for perjury as provided by law.

OWNER'S SIGNATURE Michael Reynolds Date 7/6/00

DEPARTMENT OF HEALTH USE ONLY		
<u>P.E. Design</u> Minimum Absorption Area	<u>P.E. Design</u> Minimum Tank Capacity	<u>07106100</u> Date of Site Inspection
REMARKS <u>Install absorption system per P.E. design in area of soil percolation test. The system must be inspected prior to backfill by the Health Dept. and a letter certifying the system was properly installed per the engineer design must be received by this office before final approval may be granted.</u>		
EHS INSPECTOR <u>Jane Christensen</u> DATE <u>07107100</u> <input checked="" type="checkbox"/> APPROVED <input type="checkbox"/> DENIED		
FEE NO FEE		DATE TO PLANNING / WASTEWATER <u>7-7</u>

- 1) We require a copy of your percolation (**PERC**) **TEST** with an original professional engineer's (PE) stamp and signature.
- 2) A **PLOT PLAN** must be drawn (not to scale) on a 8 1/2 x 11 sheet of paper. The plot plan must include
 - 1) a north bearing
 - 2) property lines
 - 3) property dimensions
 - 4) all buildings (proposed or existing)
 - 5) proposed septic system site
 - 6) designated alternate septic system site
 - 7) driveway (proposed or existing and name of adjoining street)
- 3) Initial any of the following features that apply to your property and include them on your plot plan.

<input checked="" type="checkbox"/> Well(s)	<input type="checkbox"/> Adjacent property well(s)	<input type="checkbox"/> Subsoil drain
<input type="checkbox"/> Cistern	<input type="checkbox"/> Water line	
- 4) Initial any of the following that are within 100 feet of your proposed septic system and include on your plot plan.

<input type="checkbox"/> Spring(s)	<input type="checkbox"/> Lake(s)
<input type="checkbox"/> Pond(s)	<input type="checkbox"/> Stream(s)
<input type="checkbox"/> Dry Gulch(es)	<input type="checkbox"/> Natural drainage course(s)
- 5) **PROPERTY ADDRESS OR LOT NUMBER MUST BE POSTED AND CLEARLY VISIBLE FROM ROAD. PERC HOLES MUST BE CLEARLY MARKED.**

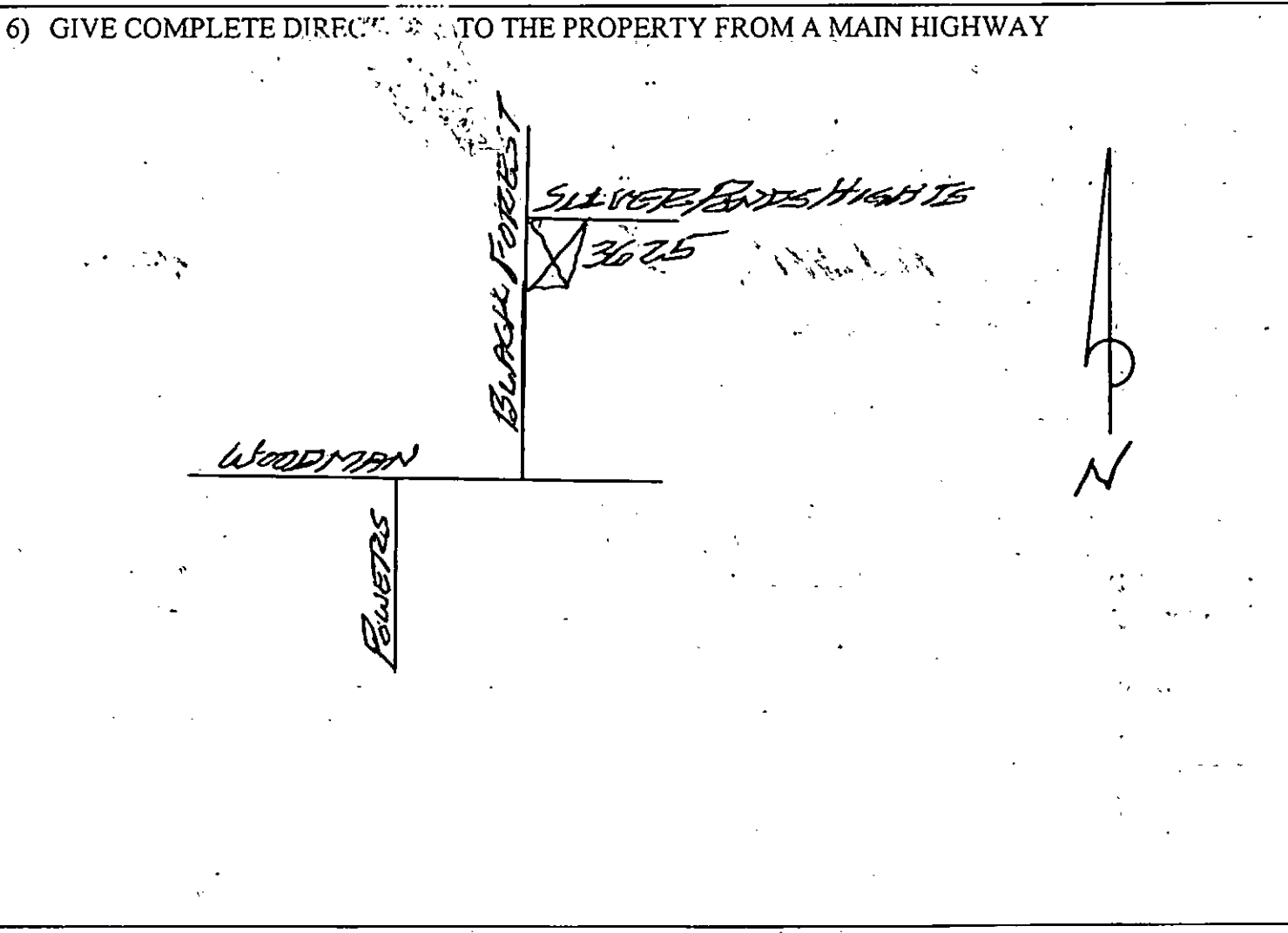

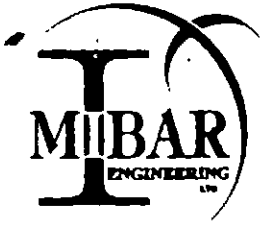

267 N. WASHINGTON STREET
P.O. BOX 581
MONUMENT, CO 80132-0581
(719) 487-0812

RECEIVED

MAR 12 2001

ELPID
ENVIRONMENTAL HEALTH SERVICES

MICHAEL F. REYNOLDS, D.E., P.E.
JOHN A. BLIND, D. PHIL., P.E.
CHARLES E. MILLIGAN, PH.D., P.E.

E

#5232303001
12/20/2000

March 9, 2001

El Paso County Health Department
Attn: Ginger Glenn
301 S. Union Blvd.
Colorado Springs, CO 80910-3123



Re: Septic System, 6825 Silver Ponds Heights

We inspected the installation of the engineered septic system at the above address at several points during its construction as well as the finished product. It has been installed in accordance with our engineered plans, specifications and county regulations. This includes having the correct size septic tanks, the proper grade on all pipes and sections of the absorption field, the correct depth, size and configuration of the absorption field, and the backfill around and over the field.

The system is ready for final certification from the El Paso County Health Department. Please call me if you have any questions.

Sincerely,

Michael F. Reynolds, P.E.

cc: Silver Office Park LLC

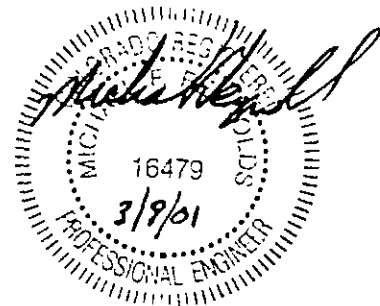

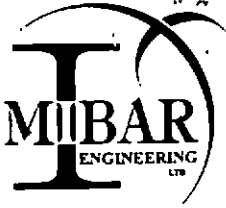

11145 TEACHOUT RD
COLORADO SPRINGS, CO 80908
PHONE: 719-495-8992
FAX: 719-495-1433

July 5, 2000

El Paso County Health Department
301 S. Union Blvd.
Colorado Springs, CO 80910

Re: Septic System, Lot 25, Silver Ponds S/D, 6825, 6835 & 6845 Silver Pond Heights

The construction of the buildings will be done in three phases, the first phase will only include Building 1, 6825 Silver Pond Heights. Building 2, 6845 Silver Pond Heights is not being planned to be done until the year 2004. If Building 3, 6835 Silver Pond Heights is ever done it will not be until 2008 or later. We wanted to show all three systems on the plan but will not install each system until the building is constructed.

We would prefer to pull a separate permit for each building starting with just Building 1 at this time.

Michael F. Reynolds, P.E.

cc: Frontier Construction, Inc.

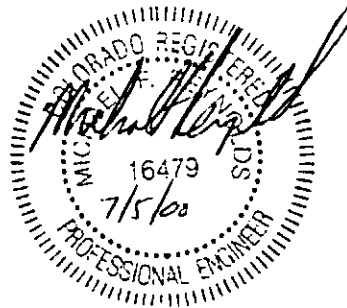



P.O. Box 1351
Monument, CO 80132
719 481-4560
Fax 481-9204

**PERCOLATION TEST
FOR
SILVER PONDS OFFICE PARK**

JOB #8022

Lot 25, Filing #1,
Silver Ponds Subdivision,
6825 Silver Ponds Heights,
El Paso County,
Colorado

Respectfully submitted,

Jeff Houchin
Geologist



Michael F. Reynolds, P.E.
Civil Engineer

PERCOLATION TEST FINDINGS

Due to encountering bedrock (sandstone) at the depth of 3.5 feet below the native ground surface, the system to be installed on this site shall be designed by a Colorado Registered Engineer.

Enclosed are the results of the percolation test for the septic system to be installed at Lot 25, Filing #1, Silver Ponds Subdivision, 6825 Silver Ponds Heights, El Paso County, Colorado. The locations of the percolation test borings were determined by Doug Pinney. The residence will not be on a public water system. Due to the natural slope of the property, the entire system will feed to the southwest at 4% at least 20 feet. All applicable regulations of the El Paso County Health Department will be complied with for the installation of the disposal system.

The percolation test was performed on June 5, 2000, in accordance with Section VI, Soil Test, ISDS Regulations, E.P.C.D.H. & E. The field data and results of the percolation test are as follows:

PERC. TEST @ TIME	PERC HOLE #1 @ 34" DEPTH DROP (IN INCHES)	PERC HOLE #2 @ DEPTH: 34" DROP (IN INCHES)	PERC HOLE #3 @ DEPTH: 34" DROP (IN INCHES)
9:50	2	1/4	1
10:00	1	1/16	1/2
10:10	1	1/16	1/2
Rate/Hole:	10	160	20

The average of the test holes is 63.3 minutes per inch.

The soil profile for the disposal system is as follows:

- 0 to 8" - Topsoil- loam, organic composition.
- 8" to 3.5' - Sand/Clay- fine grain, low density, moderate moisture content, moderate clay content, moderate plasticity, buff in color.
- 3.5' to 12' - Claystone- fine grain, moderate density, same properties as above, buff-gray in color.

No water was encountered during the drilling of all holes. Bedrock (claystone) was encountered at 3.5 feet below the native ground level. No known wells were observed within 100 feet of the proposed system. All setbacks shall conform to county regulations.

If during construction of the field itself, subsurface conditions change considerably or if the location of the proposed field changes, this office shall be notified to determine whether the conditions are adequate for the system as designed or whether a new system needs to be designed.

Weather conditions at the time of the test consisted of cloudy skies, with mild to warm temperatures.

Site Map

Lot 25, Filing 1,
Silver Ponds Subdivision,
Silver Ponds Heights,
El Paso County,
Colorado
Job #8022

Location from S.E. lot corner to Profile: N. 46° W. - 84'

Silver Ponds Heights

Location from Profile to:

- P-1: N. 57° E. - 37'
- P-2: S. 7° W. - 32'
- P-3: N. 87° W. - 30'

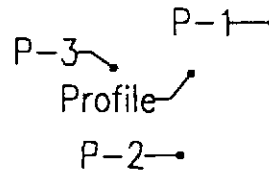

Frontrange Geotechnical

0 25 50 75
GRAPHIC SCALE IN FEET

SCALE: 1" = 75'

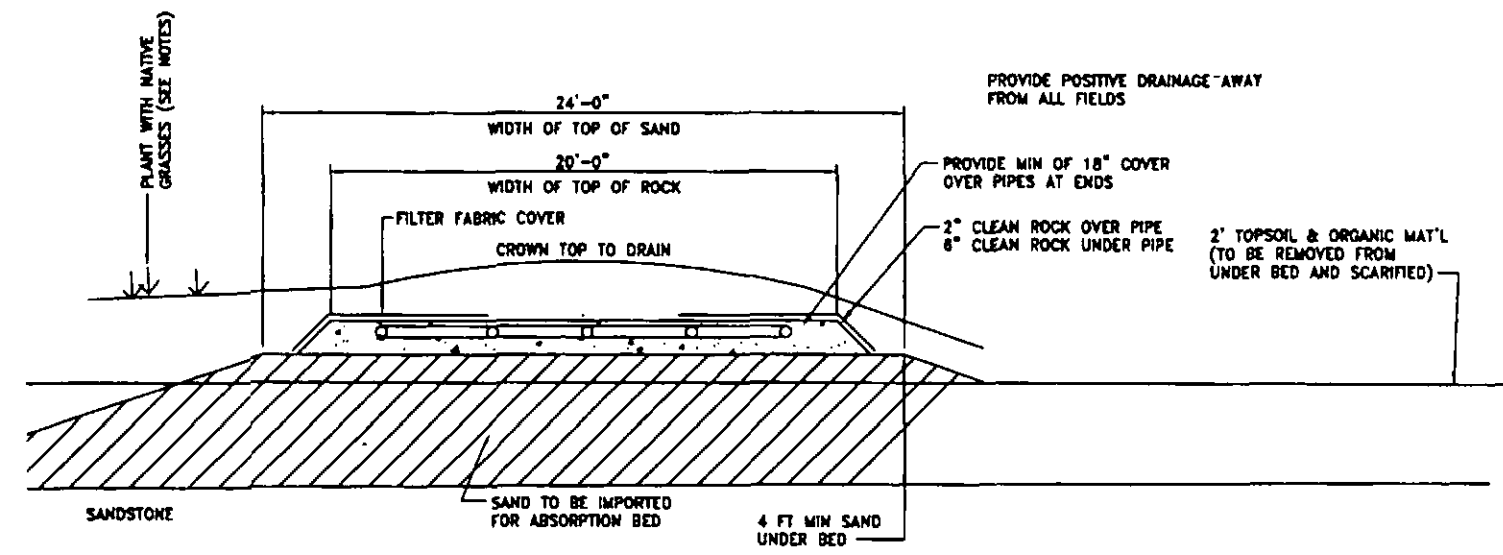

BED SECTION
N.T.S.

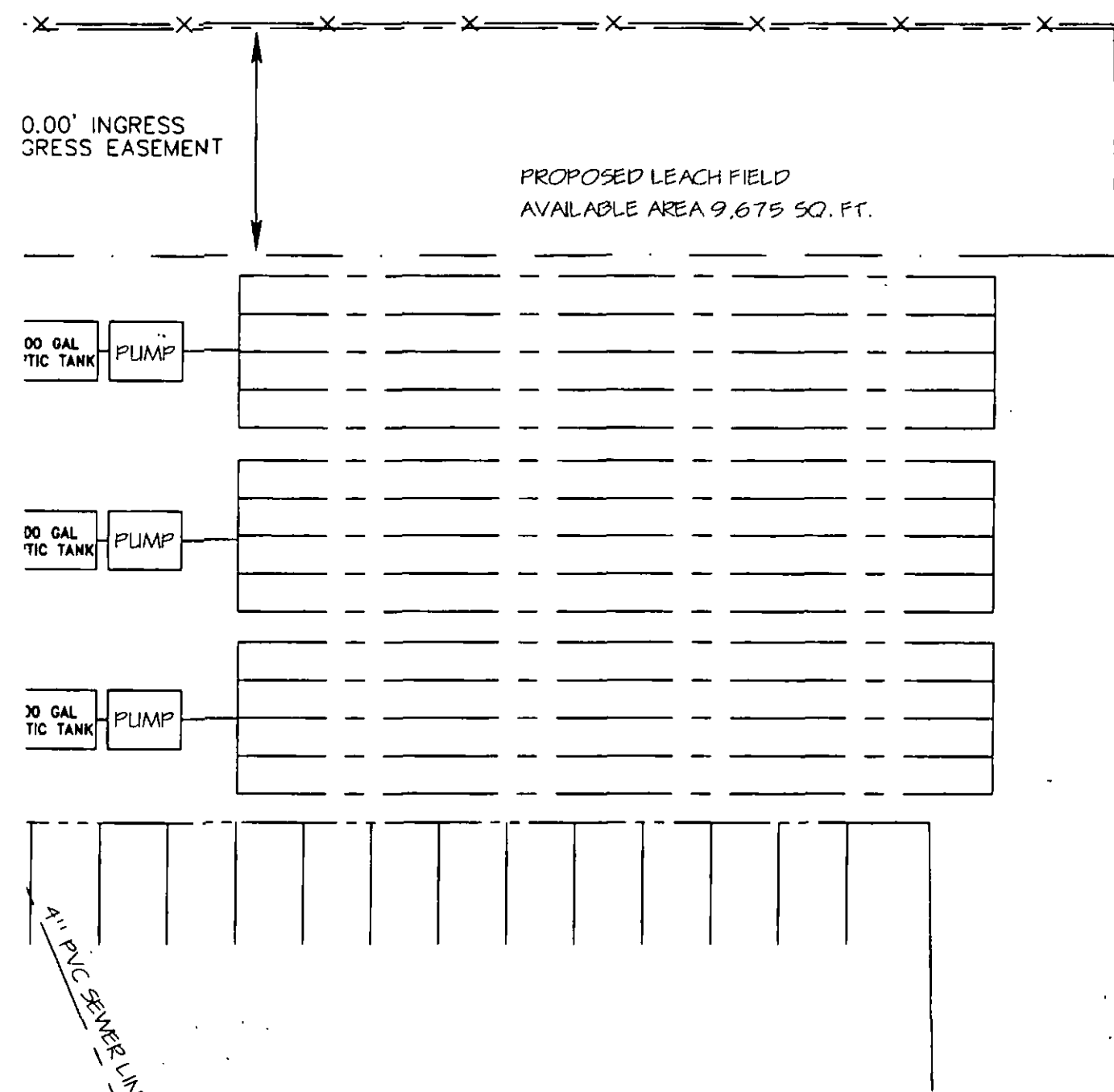

ARE AS FOLLOWS:
FIELD LOCATION
NOTION.
EFFECT THE INSTALLATION
G, ETC.
T THE FIELD AFTER
MIN COVER AND
WAY FROM FIELD.

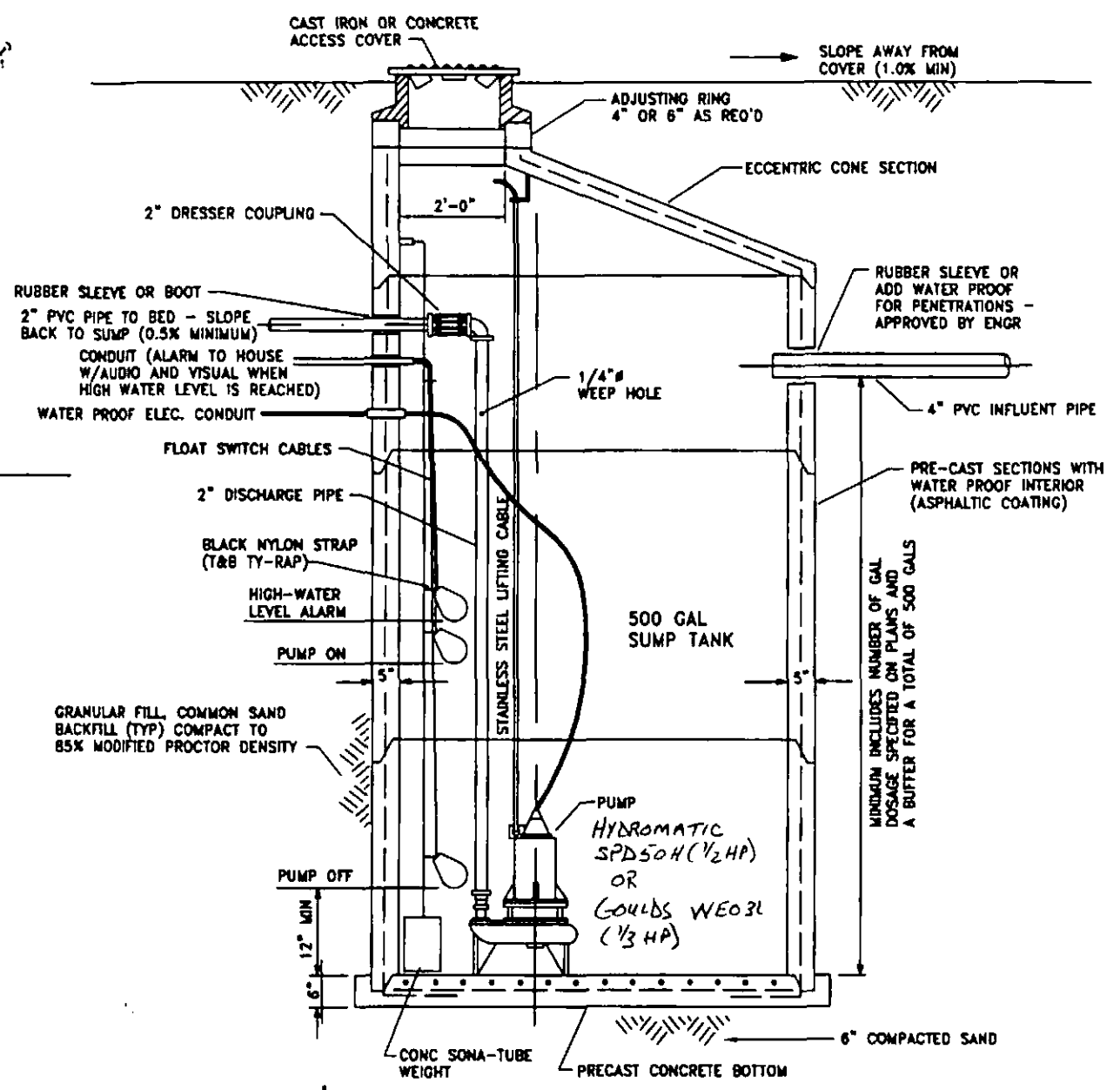

SUMP SECTION
NOT TO SCALE

NOTE: PUMP AND ALARM TO BE ON SEPARATE CIRCUITS.

APPLICANT'S INFO:

SILVER OFFICE PARK, LLC
P.O. BOX 581
MONUMENT, COLORADO 80132

719-481-8750 PHONE
719-481-2017 FAX
frontier@divide.net E-MAIL

FRONTIER
construction, llc
19890 ARIES DRIVE, MONUMENT, COLORADO 80132

JS
SEPTIC PLAN

1-STORY OFFICE BUILDING
#3

8000 SQ. FT. GROSS
7000 SQ. FT. NET

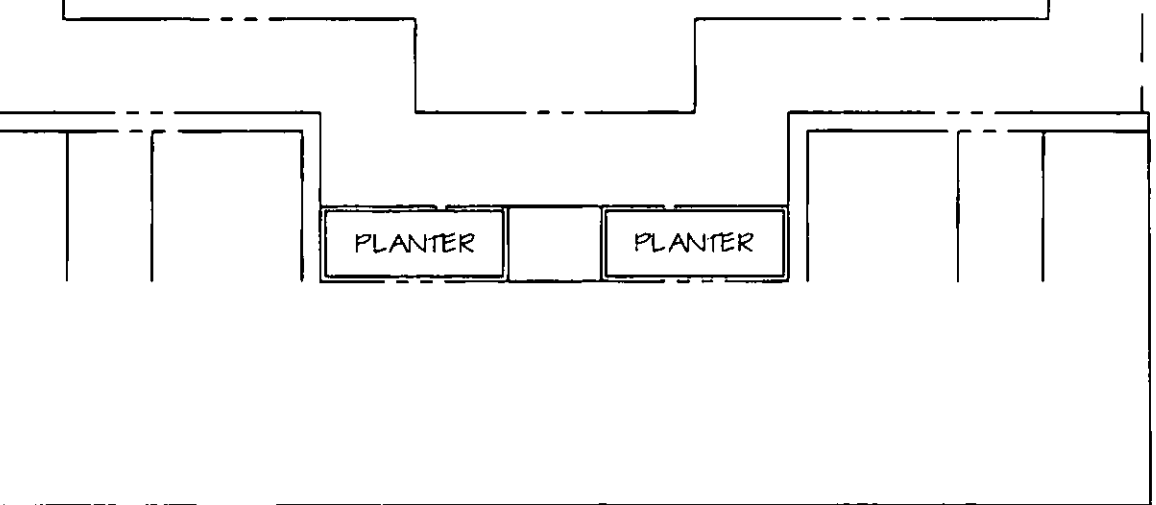

INSPECTIO.
1.) ENGINE AT TIME
2.) ENGINE OF BEL
3.) ENGINE PRIOR
ENGINE BACKFI
PROPEI

NOTES:

ALL WORK PER EL PASO COUNTY HEALTH DEPARTMENT CRITERIA.

ABSORPTION BED SHALL BE CROWNED AND COVERED WITH A MINIMUM OF 4 INCHES OF SELECT TOPSOIL TO PROVIDE A BASE FOR GOOD VEGETATIVE COVER.

CONTACT SOIL CONSERVATION SERVICE OR COUNTY EXTENSION AGENT FOR VEGETATION BEST SUITED FOR THE AREA.

PROVIDE DRAINAGE SWALE AROUND UPHILL SIDE OF FIELD.

SPECIAL NOTE:

SAND FOR ABSORPTION BED TO BE IMPORTED FROM OFF SITE AS NECESSARY TO PLACE UNDER BED; ENGINEER TO APPROVE.

TAX #52323-03-001

ZONING - PBP

PLANNED BUSINESS PARK DISTRICT

ADDRESS:

6825 SILVER PONDS HEIGHTS
COLORADO SPRINGS, COLORADO

SITE PLAN INFO

PARCEL SIZE - 3.10 ACRES

NOTES:

GRADE SURROUNDING AREA TO DRAIN AWAY FROM FIELD.

MAINTAIN 2.0% MIN AND 3.0% MAX GRADE ON PIPE FEEDING SEPTIC TANK. MAINTAIN 2.0% MIN GRADE ON PIPE FEEDING FIELD.

OWNER IS RESPONSIBLE FOR PERMIT. CONTRACTOR MUST OBTAIN APPROVAL OF ENGINEERED SYSTEM FROM EL PASO COUNTY HEALTH DEPARTMENT. OWNER/CONTRACTOR MUST VERIFY SETBACKS AND OBTAIN UTILITY CLEARANCES PRIOR TO CONSTRUCTION.

VEHICULAR OR HOOFED ANIMAL TRAFFIC OF ANY KIND OVER ANY PART OF SYSTEM MAY CAUSE PREMATURE FAILURE AND IS PROHIBITED.

CALCULATIONS:

EACH OFFICE BUILDING (52 EMPLOYEES, 1 - 8 HR SHIFT)
PERC RATE 63.3 MIN/INCH

$$A = \frac{Q \sqrt{T}}{5} (1.5)$$

$$A = \frac{(52)(15) \sqrt{63.3}}{5} (1.5)$$

$$A = 1862 \text{ SQ FT}$$

USE A 2,000 SQ FT AREA (20' x 100')

WIRE FENCE

SILVER OFFICE BUI

6825 SILVER PONDS HEIGHT
PLANNED BUSINESS PARK DISTRICT

DRAWN BY

REYNOLDS

DATE

7/5/00

MIBAR JOB NUMBER

394

SHEET

SE

APPROVAL

OWNER

OWNER

DATE

MIBAR ENGINEERING

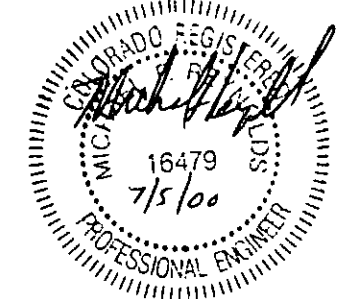

SILVER POND HEI

306.94'
S89°28'17"

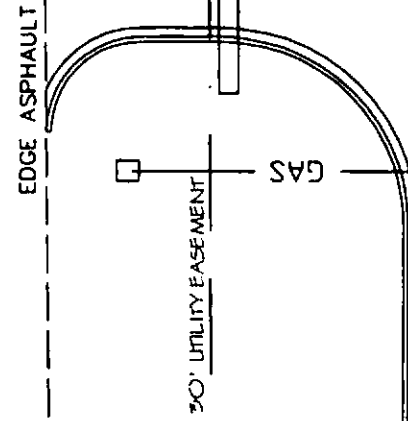

30' UTILITY EASEMENT

LANDSCAPE SETBACK

FL 24" CMP
FL 24" CMP

FL 24" CMP
FL 24" CMP

GAS GAS GAS GAS GAS GAS

4" PVC

ROOF LINE

1-STORY OFFICE BUILDING #1

7800 SQ. FT. GROSS
6800 SQ. FT. NET

PLANTER

PLANTER

1-1/4" WATER SERVICE

ASPHALTIC PAVING

WELL

LANDSCAPE SETBACK

440.02'
S00°02'12"E

PHASE #1 BOUNDARY

POWER POLE

FL 18" CMP

FL 18" CMP

BLACK FOREST ROAD
60' Right of Way

SITE PLAN

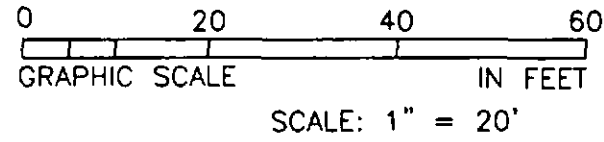

VICINITY MAP

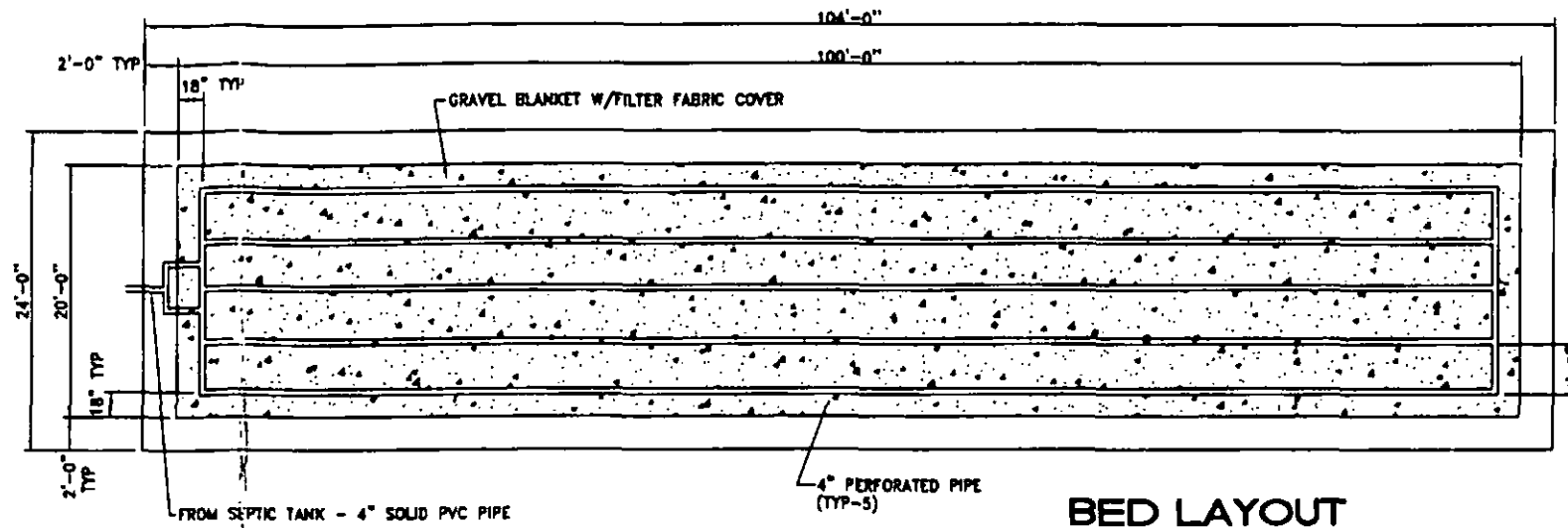
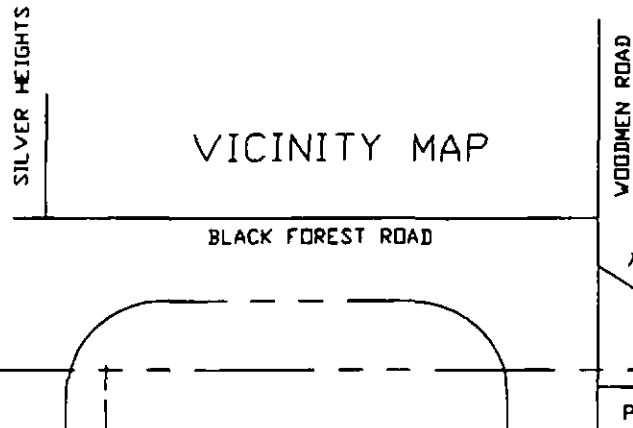

ORIGINAL (APPROX.)

BED LAYOUT
N.T.S.

WOOD FENCE

LANDSCAPE SETBACK

500'02"10"E
440.02'

50' UTILITY EASEMENT

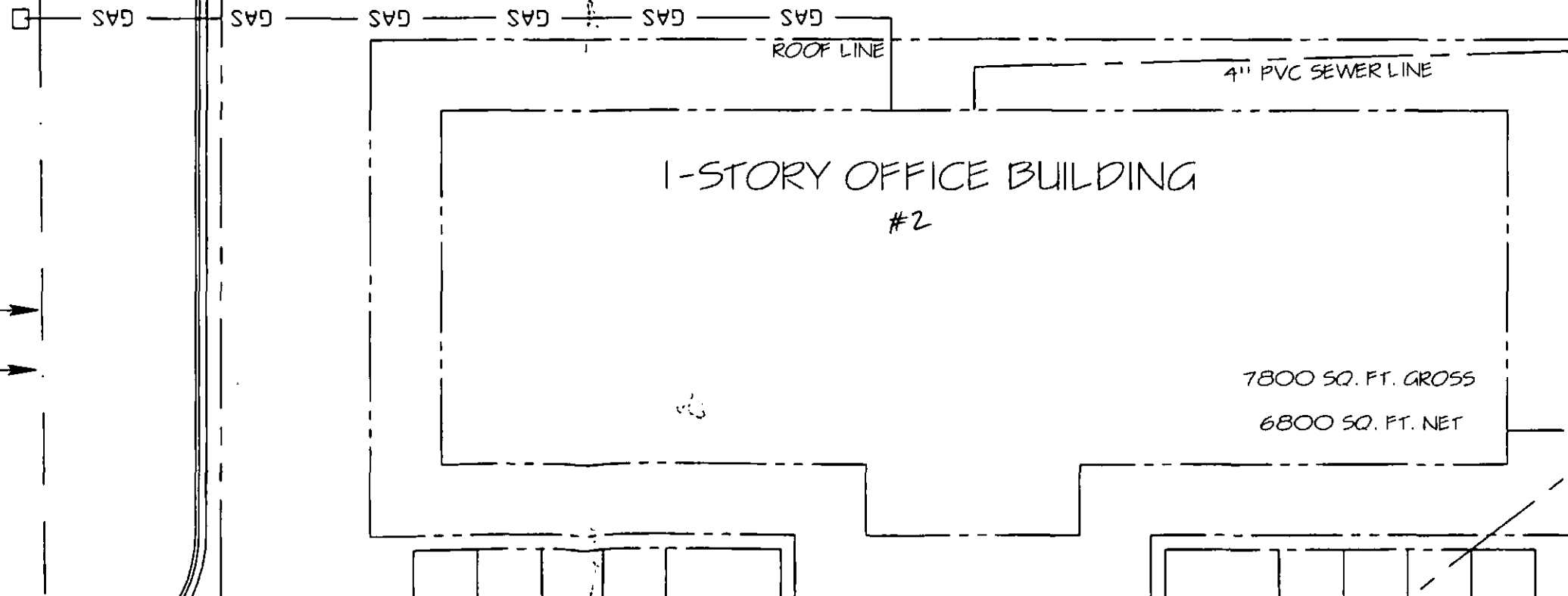

1-STORY OFFICE BUILDING
#2

7800 SQ. FT. GROSS
6800 SQ. FT. NET

60.00' INGRESS
EGRESS EASEMENT

60.00'

30.00'

30.00'