

#4305003025

P02

CITY-COUNTY HEALTH DEPARTMENT
COLORADO SPRINGS, COLORADO

SEWAGE DISPOSAL INSPECTION FORM

APPROVAL: V.A. & F.H.A.

YES ☒ NO ☐

Don. Pate

ENVIRONMENTALIST

DATE OF INSP.

4 Aug 1972

LOCATION (STREET NUMBER)

7815 Blue Hill

LEGAL DESCRIPTION

Lt 7 Blk 4 Meadow Lake Estate

CONTRACTOR

NO. OF BEDROOMS

3

TYPE OF CONSTRUCTION

SYSTEM INSTALLED BY

Doves Corp.

PRIMARY TREATMENT

COMMERCIAL MFG.

Pre cast

SIZE

1000 gal

NON. COMMERCIAL

SIZE

TYPE OF MATERIAL

NO. COMPARTMENTS

WIDTH

LENGTH

GALLONS

DEPTH (TOTAL)

LIQ. CAP.

SECONDARY TREATMENT

DISPOSAL FIELD

SOIL

PERC. TEST

TOTAL LENGTH OF TILE LINES 160' NUMBER OF LINES 2 DISTANCE BETWEEN LINES 8'

ABSORB. AREA 320' TYPE OF TILE 1000 gal b.t. TRENCH DEPTH 36" TRENCH WIDTH 24" GRADE Road

TYPE FILTER MATERIAL 3/4" gravel DEPTH 12" UNDER TILE 6" OVER TILE 2"

LEACHING PITS (NO.)

SOIL

PERC. TEST

LINING MATERIAL

CAPACITY SQ. FT.

DIAM

WORKING DEPTH

DISPOSAL BED

LENGTH

WIDTH

DEPTH

TOTAL SQ. FT.

NORTH ↑

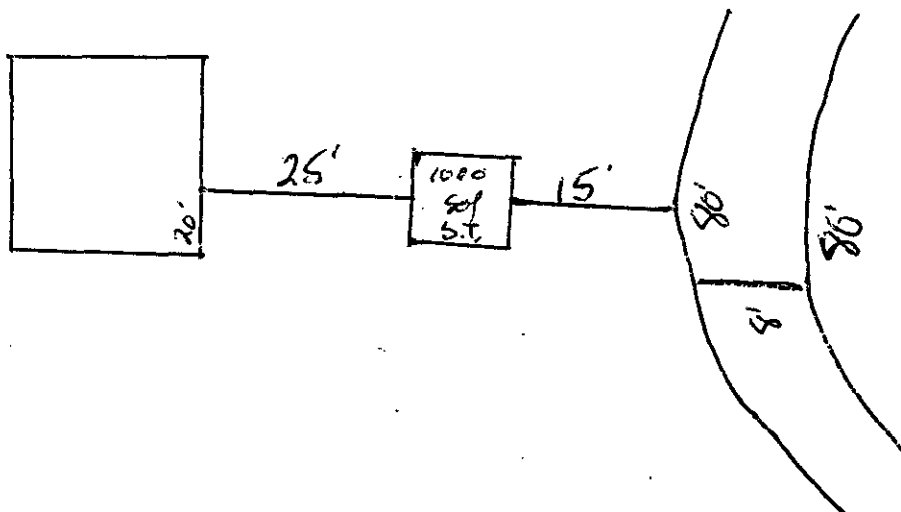

10/19

THIS PERMIT DOES NOT
DENOTE APPROVAL OF ZONING
AND ACREAGE REQUIREMENTS.

CITY-COUNTY HEALTH DEPARTMENT

Colorado Springs Colorado El Paso County

PERMIT

5 Acres @ East
w/Well Dale
No 1864

Individual Sewage Disposal System (Construction, Alteration or Repair)

Issued To Robert Irwin

Date June 26, 1972

Address of Property Lot 7, Blk 4, Meadow Lake Estates #7

(Permit valid at this address only)

Builder - Contractor - Owner Address None Excavating

Phone _____

Sewage-Disposal System work to be performed by Co

Phone _____

This Permit is issued in accordance with Regulation XII and Article 2 of Chapter 66, Colorado Revised Statutes 1963, as amended by the addition of a new Section 66-2-16. (H.B. 1205, 7-1-65). **PERMIT EXPIRES** upon completion —installation of sewage-disposal system or at the end of six (6) months from date of issue—whichever occurs first—(unless work is in progress).

December 26, 1972

(Date of Expiration)

J. A. Reich

Director, City-County Health Dept.

Permit Fee

\$ ²5.00

Mileage (8c/mile to and from site)

25.00
\$

Total Fee

Septic tank 1,000 gals. Field 300 feet of trench 2 inches wide.

150 Lin Ft

Seepage bed _____ ft. long _____ ft. wide. Seepage pit _____ gallons.

The Health Officer shall assume no responsibility in case of failure or inadequacy of a sewage-disposal system, beyond consulting in good faith with the property owner or representative.

NOTE: Leave entire sewage-disposal system uncovered for final inspection.

24-hour advance notice required.

DARLOW ENGINEERING CO.
12635 HOLMES RD.
COLO. SPGS., COLO. 80908
495-2853

5 acres w/Well
3 BR: 1,000 gal ST
Pore Rate = $100^{\circ} \times 3^{\circ} = 300^{\circ}$
 $300^{\circ} \div 2' \text{ trench} = 150'$
lin ft 2' trench

PERCULATION TEST REPORT

Test Hole: 8 in. dia. X 36 in. depth

Water Level: 10' +

Test Results: - 3 - minutes per 1 inch

	Range of each Layer ↓	Top Soil	Clay	Silt	Fine Sand	Course Sand	Gravel	Course Gravel	Other
1st	36"					✓	✓		
2nd									
3rd									
4th									
Indicate Packed or Loose						Loose			



Henry W. Danley, P.E.
Structural Engineer

Henry W. Danley

Test performed for GEORGE KIBLER
Address _____

Location of Test LOT #7 BLOCK #4
MEADOW LAKE ESTATES #1
EL PASO COUNTY
Date JUNE 23, 1972

This form must be accompanied by a plot plan (rough Sketch).

The lengths of the property lines, the position of the house relative to the property lines, the general location of the well and the septic tank and the distance from the leech field to the well (100 feet plus) must be on the sketch.