

EL PASO COUNTY DEPARTMENT OF HEALTH AND ENVIRONMENT  
INDIVIDUAL SEWAGE DISPOSAL SYSTEM INSPECTION FORM

Permit # 96-23 **P**  
Date April 18, 96  
ENVIRONMENTALIST J. Markowski

APPROVED: YES  NO  #4208003001

Address 13360 HAZIAT CIRCLE Owner HARRY LEONARD

Legal Description LOT 3 FILING NO. 2  
Residence  # of bedrooms 3; Commercial ; System Installer Owner

**SEPTIC TANK:**  
Commercial ; Noncommercial   
Construction Material in last concrete L      W      WD       
capacity 1500 gallons.

**DISPOSAL FIELD:**  
**Rock Systems:**  
Trench: depth 18", width 2', total length 179', sq. feet 5374'  
Bed: depth     , length     , width     , sq. feet       
Rock type Blue Rock, depth 12", under PVC 6", over PVC 3"  
Seepage Pits: # of pits     , total # of rings     , working depth(s)       
size of pit(s) L X W     , lining material     , total sq. feet     

**Rockless Systems:**  
Chamber: Type     , number of chambers     , bed     , trench       
sq. ft./section     , reduction allowed     %, sq. ft. required       
total sq. ft. installed     , depth of installation     

Engineer Design Y or N     , Designing Engineer       
Approval letter provided? Y or N       
Well 50 feet from tank  or N      100 feet from leach field  or N       
Well installed at time of septic system inspection  or N      Public Water       
\*Approval will be revoked if in the future the well is found to be within 50 feet of the septic tank and/or 100 feet of the disposal field.

NOTES: ① = perforated line (piping)  
② = solid piping

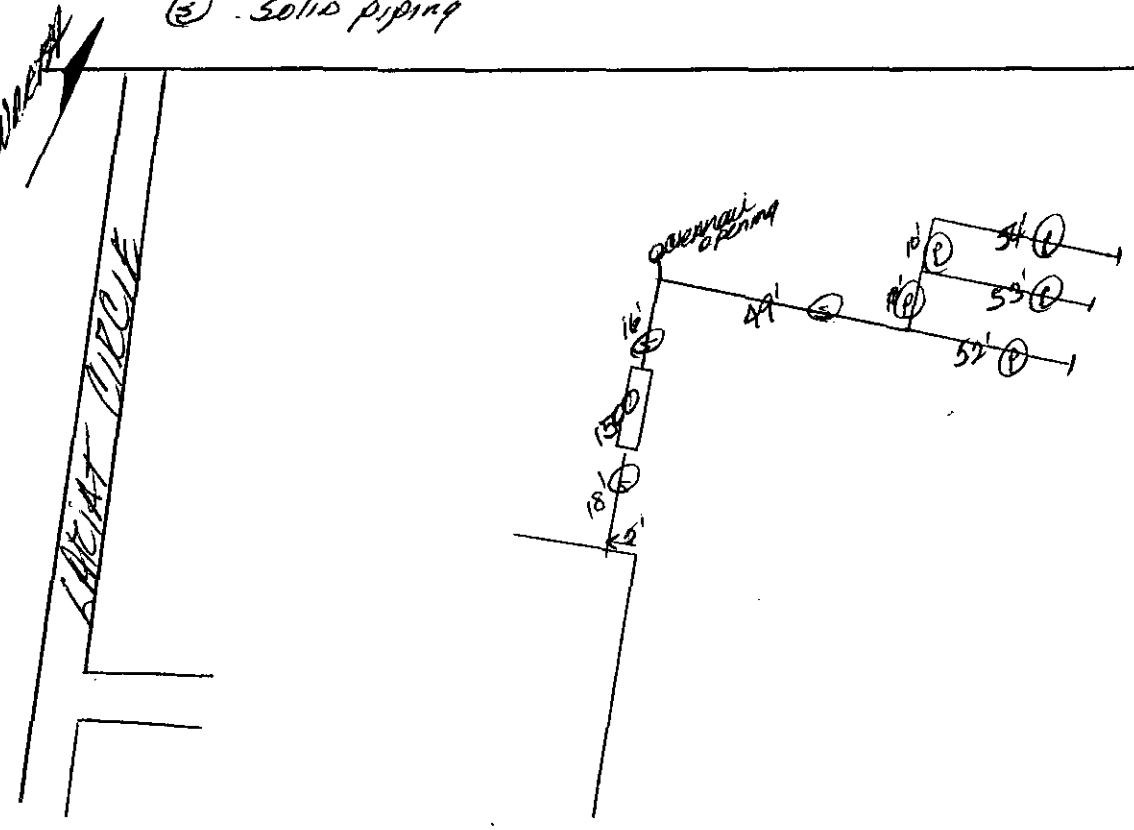

• WELL

Acres 5 **EL PASO COUNTY • DEPARTMENT OF HEALTH AND ENVIRONMENT**

301 South Union Blvd. • Colorado Springs, Colorado • 578-3325

Water Supply well

Permit 9693

**PERMIT**

**TO CONSTRUCT, ALTER, REPAIR OR MODIFY ANY INDIVIDUAL SEWAGE DISPOSAL SYSTEM**

Receipt No. ym

Issued to LARRY LEONARD

Date 11-21-95

Address of Property 13360 LARIAT CIRCLE, LOT 3, FIL. 3

Phone 447-8676

(Permit valid at this address only)

Sewage-Disposal System work to be performed by OWNER Phone \_\_\_\_\_

This Permit is issued in accordance with 25-10-106 Colorado Revised Statutes 1973, as amended. PERMIT EXPIRES upon completion installation of sewage-disposal system or at the end of twelve (12) months from date of issue—whichever occurs first—(unless work is in progress). This permit is revokable if all stated requirements are not met.

**-THIS PERMIT DOES NOT DENOTE APPROVAL OF ZONING AND ACREAGE REQUIREMENTS-**

\$150.00

PERMIT FEE (NOT REFUNDABLE)

11-21-96

DATE OF EXPIRATION

[Signature]  
DIRECTOR, DEPARTMENT OF HEALTH AND ENVIRONMENT

[Signature]  
ENVIRONMENTALIST

**NOTE: LEAVE ENTIRE SEWAGE-DISPOSAL SYSTEM UNCOVERED FOR FINAL INSPECTION. 48 HOUR ADVANCE NOTICE REQUIRED.**

SEPTIC TANK:	TRENCH SYSTEM:	BED SYSTEM:	SEEPAGE PIT SYSTEM:
total square feet	total square feet	total square feet	total square feet
1250	487		
gallons	ft. of trench inches wide		rings or diam.x w/d
	ft. of trench inches wide		

**NOTES:** System to be installed per regulations. All minimum distances are to be met. Ground water found at 7 feet, 6 inches, bedrock present at 7 feet. Per engineer, "A reduction for use of a chambered system is not recommended". Also, per engineer "the field shall be no deeper than 18 inches below the existing ground surface."

The Health Office shall assume no responsibility in case of failure or inadequacy of a sewage-disposal system, beyond consulting in good faith with the property owner or representative. Free access to the property shall be authorized at reasonable time for the purpose of making such inspections as are necessary to determine compliance with requirements of this law.

EL PASO COUNTY DEPARTMENT OF HEALTH AND ENVIRONMENT  
301 South Union Boulevard  
Colorado Springs, CO 80910-3123

New

Don

APPLICATION FOR A PERMIT TO CONSTRUCT, REMODEL, OR INSTALL  
A SEWAGE DISPOSAL SYSTEM

Name of Owner LARRY LEONARD Daytime Phone 447-8676

Address of Property 13360 LARIAT CIRCLE D.P.#60 Date 11-20-95

Legal Description of Property 17190 City Est. File # 2 lot 3, Replat of 42448

Tax Schedule Number 42-08003001 Septic Contractor/Phone 447-8676

Type of House Construction CONCRETE & WOOD Source of Water WELL

Size of Lot 5 ACRES Basement (Y or N) (N) Percolation Test Attached (Y or N) (Y)

MAXIMUM POTENTIAL NUMBER OF BEDROOMS 3

I have supplied a plot plan as described on the back of this form. I acknowledge the completeness of the application is conditional upon such further mandatory & additional tests & reports as may be required by the Department to be made & furnished by the applicant for purposes of evaluating the application, & issuance of the permit is subject to such terms & conditions as deemed necessary to ensure compliance with rules & regulations adopted pursuant to C.R.S. 1973, 10-25-101 et. seq. I hereby certify all statements made, information and reports submitted by me are or will be represented to be true & correct to the best of my knowledge & belief, & are designed to be relied on by the El Paso County Department of Health in evaluating the same for purposes of issuing the permit applied for herein. I further understand any falsification or misrepresentation may result in the denial of the application or revocation of any permit granted based upon said application & in legal action for perjury as provided by law.

OWNER'S SIGNATURE [Signature]

\*\*\*\*\*  
DEPARTMENT OF HEALTH USE ONLY

Absorption Area 487 ft<sup>2</sup> Tank Capacity 1250 gal Date/Site Inspection 11/21/95

Remarks: System to be installed per regulations. All minimum distances are to be met. Ground water found at 7' feet 6" inches, bedrock present at 7' feet. Per engineer, "A reduction for use of a chambered system is not recommended". Also per engineer "the field shall be no deeper than 18 inches below the existing ground surface." SEE Letter from Engineer attached.

Application is (  ) approved (  ) denied

Environmentalist Myellowski, D Date Nov 21, 95

Permit # 9693 Receipt # jm 11/21/95 Date to Planning Dept attached (K)

**PROPERTY AND PERC HOLES MUST BE CLEARLY MARKED/POSTED**

The following information must be on your plot plan.  
Please check ( ) the items that apply.

- Property Lines
- Property Dimensions
- Proposed Septic System Site
- Well(s)
- Adjacent Well(s)
- Building(s)
- Proposed Building(s)
- Water Line
- Cistern
- Subsoil Drain(s)

Are any of these within 100 feet of your proposed septic system (including adjoining property)? Also draw on the plot plan.

Spring(s) \_\_\_\_\_  
Lake(s) \_\_\_\_\_  
Pond(s) \_\_\_\_\_  
Stream(s) \_\_\_\_\_  
Dry Gulch(s) \_\_\_\_\_  
Natural Drainage Course(s) \_\_\_\_\_

---

Give complete directions to the property from a main highway.

WOODMEN NORTH TO LATIGO BLVD EAST  
TO HESLEIGH TRAIL TO HARIET CIRCLE